

LETOURNEAU, KATHY A
LETOURNEAU, GARY
45 LITCHFIELD RD
BOWDOIN ME 04287

B2340P47 B2772P39

Property Data			Assessment Record				
Neighborhood	5 Map 5		Year	Land	Buildings	Exempt	Total
Tree Growth Year	0		2009	43,600	0	0	43,600
Farmland Yr	0		2010	43,600	0	0	43,600
Open Space Yr	0		2011	43,600	0	0	43,600
Zone/Land Use	11 Residential 1		2012	43,600	0	0	43,600
Secondary Zone			2013	43,600	0	0	43,600
			2014	43,600	0	0	43,600
			2015	43,600	0	0	43,600
Topography			2016	43,600	0	0	43,600
1.Level	4.Below St	7.LevelBog					
2.Rolling	5.Low	8.Conform	2017	43,600	0	0	43,600
3.Above St	6.FZone	9.Non-Confor					
Utilities			2018	43,600	0	0	43,600
1.Public	4.Dr Well	7.Cesspool					
2.Water	5.Dug Well	8.	2019	43,600	0	0	43,600
3.Sewer	6.Septic	9.None					
Street 1 Paved			2020	43,600	0	0	43,600
1.Paved	4.Proposed	7.MHG					
2.Semi Imp	5.R/O/W	8.DIS	2021	43,600	0	0	43,600
3.Gravel	6.MHP	9.None					
TG PLAN YEAR 0			2022	43,600	0	0	43,600
Tif District # 0							

Inspection Witnessed By:

X

Date

No./Date	Description	Date Insp.

Notes:

Bowdoin

Sale Data		
Sale Date	1/14/2004	
Price		
Sale Type	1 Land Only	
1.Land	4.Mobile	7.C/I L&B
2.L & B	5.Other	8.
3.Building	6.C/I Land	9.
Financing		
1.Convent	4.Seller	7.
2.FHA/VA	5.Private	8.
3.Assumed	6.Cash	9.Unknown
Validity 2 Related Parties		
1.Valid	4.Split	7.Renovate
2.Related	5.Partial	8.Other
3.Distress	6.Exempt	9.Short
Verified		
1.Buyer	4.Agent	7.Family
2.Seller	5.Pub Rec	8.Other
3.Lender	6.MLS	9.

Land Data						
Front Foot	Type	Effective		Influence		Influence Codes
		Frontage	Depth	Factor	Code	
11.Road Frontage				%		1.Unimproved
12.Delta Triangle				%		2.Excess Frtg
13.Nabla Triangle				%		3.Topography
14.Rear Land				%		4.Size/Shape
15.Miscellaneous				%		5.Access
				%		6.Restriction
				%		7.Open Space
				%		8.View/Environ
				%		9.Fract Share
				%		30.Rear Land 3
				%		31.Tillable
				%		32.Pasture
				%		33.Orchard
				%		34.Software F&O
				%		35.Mixed Wood F&O
				%		36.Hardwood F&O
				%		37.Software TG
				%		38.Mixed Wood TG
				%		39.Hardwood TG
				%		40.Wasteland
				%		41.Commercial
				%		42.2nd Site
				%		43.Post Rd
				%		44.Lot Improvemen
				%		45.Subdivision Lo
				%		46.Golf Course
		Total Acreage		25.00		

Bowdoin

Map Lot 05-33-0

Account 503

Location 18 LETOURNEAU DR

Card 1 Of 1 7/19/2022

Building Style 0 Not Coded	SF Bsmt Living 0	Layout 0
0.Not Code 4.Cape 8.Log	Fin Bsmt Grade 0 0	1.Typical 4. 7.
1.Conv. 5.Garrison 9.Other	OCCUPANCY 0	2.Inadeq 5. 8.
2.Ranch 6.Split 10.DW	Heat Type 100% 0 Not Coded	3.Poor 6. 9.
3.R Ranch 7.Contemp 11.Church	0.Not Code 4.Steam 8.FI/Wall	Attic 0
Dwelling Units 0	1.HWBB 5.FWA 9.No Heat	1.1/4 Fin 4.Full Fin 7.
Other Units 0	2.HWCI 6.GravWA 11.	2.1/2 Fin 5.FI/Stair 8.
Stories 0	3.H Pump 7.Electric 12.	3.3/4 Fin 6. 9.None
1.1 4.1.5 7.4	Cool Type 0% 9 None	Insulation 0
2.2 5.1.75 8.20	1.Refrig 4.W&C Air 7.	1.Full 4.Minimal 7.
3.3 6.2.5 9.Yurt	2.Evapor 5. 8.	2.Heavy 5. 8.
Exterior Walls 0 Not Coded	3.H Pump 6. 9.None	3.Capped 6. 9.None
0.Not Code 4.Asbestos 8.Concrete	Kitchen Style 0	Unfinished % 0%
1.Wood 5.Stucco 9.Other	1.Modern 4.Obsolete 7.	Grade & Factor 0 0%
2.Vin/Al 6.Brick 10.Board B	2.Typical 5. 8.	1.E Grade 4.B Grade 7.
3.Compos. 7.Stone 12.	3.Old Type 6. 9.None	2.D Grade 5.A Grade 8.
Roof Surface 0	Bath(s) Style 0	3.C Grade 6.AA Grade 9.Same
1.Asphalt 4.Composit 7.	1.Modern 4.Obsolete 7.	SQFT (Footprint) 0
2.Slate 5.Wood 8.	2.Typical 5. 8.	Condition 0
3.Metal 6.Other 9.	3.Old Type 6. 9.None	1.Poor 4.Avg 7.V G
SF Masonry Trim 0	# Rooms 0	2.Fair 5.Avg+ 8.Exc
SEPTIC DESIGN 0	# Bedrooms 0	3.Avg- 6.Good 9.Same
BLDG PERMIT 0	# Full Baths 0	Phys. % Good 0%
Year Built 0	# Half Baths 0	Funct. % Good 100%
Year Remodeled 0	# Addn Fixtures 0	Functional Code 9 None
Foundation 0	# Fireplaces 0	1.Incomp 4.Delap 7.No Power
1.Concrete 4.Wood 7.		2.O-Built 5.Bsmt 8.LongTerm
2.C Block 5.Slab 8.		3.Damage 6.Dbwd 9.None
3.Br/Stone 6.Piers 9.		Econ. % Good 100%
Basement 0		Economic Code None
1.1/4 Bmt 4.Full Bmt 7.		0.None 3.No Power 7.
2.1/2 Bmt 5.None 8.		1.Location 4.Generate 8.
3.3/4 Bmt 6. 9.None		2.Encroach 9.None 9.
Bsmt Gar # Cars 0		Entrance Code 0
Wet Basement 0		1.Interior 4.Vacant 7.Entered
1.Dry 4. 7.		2.Refusal 5.Estimate 8.No
2.Damp 5. 8.		3.Informed 6.Reviewed 9.Land
3.Wet 6. 9.		Information Code 0
		1.Owner 4.Agent 7.
		2.Relative 5.Estimate 8.
		3.Tenant 6.Other 9.



Date Inspected

Additions, Outbuildings & Improvements							
Type	Year	Units	Grade	Cond	Phys.	Funct.	Sound Value
					%	%	1.One Story Fram
					%	%	2.Two Story Fram
					%	%	3.Three Story Fr
					%	%	4.1 & 1/2 Story
					%	%	5.1 & 3/4 Story
					%	%	6.2 & 1/2 Story
					%	%	21.Open Frame Por
					%	%	22.Encl Frame Por
					%	%	23.Attached Garag
					%	%	24.Frame Shed
					%	%	25.Frame Bay Wind
					%	%	26.1SFr Overhang
					%	%	27.Unfin Basement
					%	%	28.Unfinished Att
					%	%	29.Finished Attic

LETOURNEAU, GARY
5 LETOURNEAU DR
BOWDOIN ME 04287

B1115P25

Inspection Witnessed By:

X

Date

No./Date	Description	Date Insp.

Notes:

Bowdoin

Property Data			Assessment Record						
Neighborhood 5 Map 5			Year	Land	Buildings	Exempt	Total		
Tree Growth Year 0			2009	35,900	149,460	13,000	172,360		
Farmland Yr 0			2010	35,900	151,150	10,000	177,050		
Open Space Yr 0			2011	35,900	151,150	10,000	177,050		
Zone/Land Use 11 Residential 1			2012	42,900	151,150	10,000	184,050		
Secondary Zone			2013	42,900	151,150	10,000	184,050		
Topography			2014	42,900	151,150	10,000	184,050		
1.Level 4.Below St 7.LevelBog			2015	42,900	151,150	10,000	184,050		
2.Rolling 5.Low 8.Conform			2016	42,900	151,150	15,000	179,050		
3.Above St 6.FZone 9.Non-Confor			2017	42,900	159,530	20,000	182,430		
Utilities			2018	42,900	159,530	20,000	182,430		
1.Public 4.Dr Well 7.Cesspool			2019	42,900	162,830	20,000	185,730		
2.Water 5.Dug Well 8.			2020	42,900	162,830	25,000	180,730		
3.Sewer 6.Septic 9.None			2021	42,900	162,830	25,000	180,730		
Street 5 Right-Of-Way			2022	42,900	155,720	21,500	177,120		
1.Paved 4.Proposed 7.MHG			Land Data						
2.Semi Imp 5.R/O/W 8.DIS									
3.Gravel 6.MHP 9.None			Front Foot	Type	Effective		Influence		Influence Codes
TG PLAN YEAR 0			11.Road Frontage		Frontage	Depth	Factor	Code	
Tif District # 0			12.Delta Triangle				%		1.Unimproved
Sale Data			13.Nabla Triangle				%		2.Excess Frtg
Sale Date			14.Rear Land				%		3.Topography
Price			15.Miscellaneous				%		4.Size/Shape
Sale Type							%		5.Access
1.Land 4.Mobile 7.C/I L&B			Square Foot	Square Feet					6.Restriction
2.L & B 5.Other 8.			16.Regular Lot				%		7.Open Space
3.Building 6.C/I Land 9.			17.Secondary Lot				%		8.View/Environ
Financing			18.Hydro Facility				%		9.Fract Share
1.Convent 4.Seller 7.			19.Improvements				%		Acres
2.FHA/VA 5.Private 8.			20.Base 3 (Fract)				%		30.Rear Land 3
3.Assumed 6.Cash 9.Unknown							%		31.Tillable
Validity			Fract. Acre	Acres/Sites					32.Pasture
1.Valid 4.Split 7.Renovate			21.Base 1 (Fract)	51	1.00	100	%	0	33.Orchard
2.Related 5.Partial 8.Other			22.Base 2 (Fract)	28	1.00	100	%	0	34.Softwood F&O
3.Distress 6.Exempt 9.Short			23.Base 3	44	1.00	100	%	0	35.Mixed Wood F&O
Verified			Acres				%		36.Hardwood F&O
1.Buyer 4.Agent 7.Family			24.Base 1				%		37.Softwood TG
2.Seller 5.Pub Rec 8.Other			25.Base 2				%		38.Mixed Wood TG
3.Lender 6.MLS 9.			26.Frontage 1				%		39.Hardwood TG
			27.Rear Land 4				%		40.Wasteland
			28.Rear Land 1				%		41.Commercial
			29.Rear Land 2				%		42.2nd Site
			Total Acreage		2.00				43.Post Rd
									44.Lot Improvemen
									45.Subdivision Lo
									46.Golf Course

Bowdoin

Map Lot 05-33-01

Account 504

Location 5 LETOURNEAU DR

Card 1 Of 1 7/19/2022

Building Style 3 Raised Ranch	SF Bsmt Living 782	Layout 1 Typical
0.Not Code 4.Cape 8.Log	Fin Bsmt Grade 3 105	1.Typical 4. 7.
1.Conv. 5.Garrison 9.Other	OCCUPANCY 0	2.Inadeq 5. 8.
2.Ranch 6.Split 10.DW	Heat Type 100% 1 Hot Water BB	3.Poor 6. 9.
3.R Ranch 7.Contemp 11.Church	0.Not Code 4.Steam 8.F/Wall	Attic 9 None
Dwelling Units 1	1.HWBB 5.FWA 9.No Heat	1.1/4 Fin 4.Full Fin 7.
Other Units 0	2.HWCI 6.GravWA 11.	2.1/2 Fin 5.F/Stair 8.
Stories 1 One Story	3.H Pump 7.Electric 12.	3.3/4 Fin 6. 9.None
1.1 4.1.5 7.4	Cool Type 0% 9 None	Insulation 1 Full
2.2 5.1.75 8.20	1.Refrig 4.W&C Air 7.	1.Full 4.Minimal 7.
3.3 6.2.5 9.Yurt	2.Evapor 5. 8.	2.Heavy 5. 8.
Exterior Walls 2 Vinyl/Aluminum	3.H Pump 6. 9.None	3.Capped 6. 9.None
0.Not Code 4.Asbestos 8.Concrete	Kitchen Style 2 Typical	Unfinished % 0%
1.Wood 5.Stucco 9.Other	1.Modern 4.Obsolete 7.	Grade & Factor 3 Average 105%
2.Vin/Al 6.Brick 10.Board B	2.Typical 5. 8.	1.E Grade 4.B Grade 7.
3.Compos. 7.Stone 12.	3.Old Type 6. 9.None	2.D Grade 5.A Grade 8.
Roof Surface 1 Asphalt Shingles	Bath(s) Style 2 Typical Bath(s)	3.C Grade 6.AA Grade 9.Same
1.Asphalt 4.Composit 7.	1.Modern 4.Obsolete 7.	SQFT (Footprint) 1042
2.Slate 5.Wood 8.	2.Typical 5. 8.	Condition 4 Average
3.Metal 6.Other 9.	3.Old Type 6. 9.None	1.Poor 4.Avg 7.V G
SF Masonry Trim 0	# Rooms 7	2.Fair 5.Avg+ 8.Exc
SEPTIC DESIGN 0	# Bedrooms 3	3.Avg- 6.Good 9.Same
BLDG PERMIT 0	# Full Baths 1	Phys. % Good 0%
Year Built 1988	# Half Baths 1	Funct. % Good 100%
Year Remodeled 0	# Addn Fixtures 0	Functional Code 9 None
Foundation 1 Concrete	# Fireplaces 0	1.Incomp 4.Delap 7.No Power
1.Concrete 4.Wood 7.		2.O-Built 5.Bsmt 8.LongTerm
2.C Block 5.Slab 8.		3.Damage 6.Dbwd 9.None
3.Br/Stone 6.Piers 9.		Econ. % Good 100%
Basement 4 Full Basement		Economic Code None
1.1/4 Bmt 4.Full Bmt 7.		0.None 3.No Power 7.
2.1/2 Bmt 5.None 8.		1.Location 4.Generate 8.
3.3/4 Bmt 6. 9.None		2.Encroach 9.None 9.
Bsmt Gar # Cars 0		Entrance Code 5 Estimated
Wet Basement 1 Dry Basement		1.Interior 4.Vacant 7.Entered
1.Dry 4. 7.		2.Refusal 5.Estimate 8.No
2.Damp 5. 8.	3.Informed 6.Reviewed 9.Land	
3.Wet 6. 9.	Information Code 5 Estimate	
		1.Owner 4.Agent 7.
		2.Relative 5.Estimate 8.
		3.Tenant 6.Other 9.

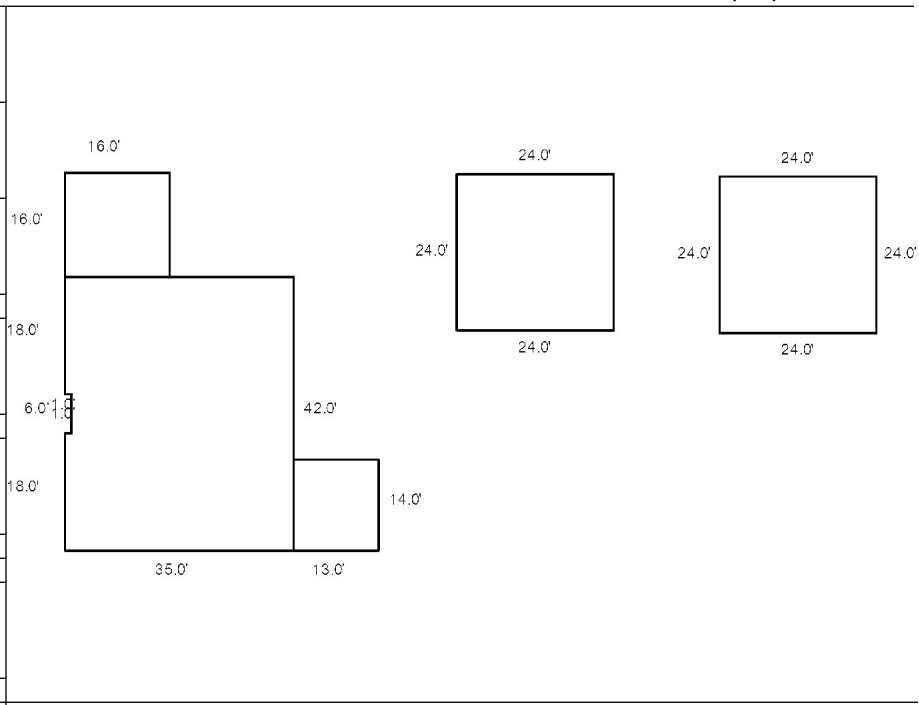

Date Inspected 3/27/2019

Additions, Outbuildings & Improvements

Type	Year	Units	Grade	Cond	Phys.	Funct.	Sound Value
30 Detached Garage	1996	576	3 100	4	0 %	100 %	
22 Encl Frame Porch	1996	256	3 100	4	0 %	100 %	
22 Encl Frame Porch	2004	256	3 100	4	0 %	100 %	
68 Wood Deck	1988	182	3 100	4	0 %	100 %	
22 Encl Frame Porch	2017	256	3 100	4	0 %	100 %	
24 Frame Shed	2018	384	3 100	4	0 %	100 %	
					%	%	
					%	%	
					%	%	
					%	%	
					%	%	



OCT 17 2006

LETOURNEAU, KATHY A
LETOURNEAU, GARY L
45 LITCHFIELD RD
BOWDOIN ME 04287

B2895P306

Previous Owner
BOWDOIN, TOWN OF
P.O. BOX 35

BOWDOIN ME 04287
Sale Date: 8/03/2007

Inspection Witnessed By:

X Date

No./Date	Description	Date Insp.

Notes:

Bowdoin

Property Data			Assessment Record						
Neighborhood 5 Map 5			Year	Land	Buildings	Exempt	Total		
Tree Growth Year 0			2009	11,380	0	0	11,380		
Farmland Yr 0			2010	11,380	0	0	11,380		
Open Space Yr 0			2011	11,380	0	0	11,380		
Zone/Land Use 11 Residential 1			2012	1,000	0	0	1,000		
Secondary Zone			2013	1,000	0	0	1,000		
Topography			2014	1,000	0	0	1,000		
1.Level 4.Below St 7.LevelBog			2015	1,000	0	0	1,000		
2.Rolling 5.Low 8.Conform			2016	1,000	0	0	1,000		
3.Above St 6.FZone 9.Non-Confor			2017	1,000	0	0	1,000		
Utilities			2018	1,000	0	0	1,000		
1.Public 4.Dr Well 7.Cesspool			2019	1,000	0	0	1,000		
2.Water 5.Dug Well 8.			2020	1,000	0	0	1,000		
3.Sewer 6.Septic 9.None			2021	1,000	0	0	1,000		
Street 1 Paved			2022	1,000	0	0	1,000		
1.Paved 4.Proposed 7.MHG			Land Data						
2.Semi Imp 5.R/O/W 8.DIS			Front Foot	Type	Effective		Influence		Influence Codes
3.Gravel 6.MHP 9.None					Frontage	Depth	Factor	Code	
TG PLAN YEAR 0			11.Road Frontage					1.Unimproved	
Tif District # 0			12.Delta Triangle					2.Excess Frtg	
Sale Data			13.Nabla Triangle					3.Topography	
Sale Date 8/03/2007			14.Rear Land					4.Size/Shape	
Price 500			15.Miscellaneous					5.Access	
Sale Type 1 Land Only								6.Restriction	
1.Land 4.Mobile 7.C/I L&B								7.Open Space	
2.L & B 5.Other 8.			Square Foot	Square Feet				8.View/Environ	
3.Building 6.C/I Land 9.			16.Regular Lot					9.Fract Share	
Financing 1 Conventional			17.Secondary Lot					Acres	
1.Convent 4.Seller 7.			18.Hydro Facility					30.Rear Land 3	
2.FHA/VA 5.Private 8.			19.Improvements					31.Tillable	
3.Assumed 6.Cash 9.Unknown			20.Base 3 (Fract)					32.Pasture	
Validity 1 Arms Length Sale								33.Orchard	
1.Valid 4.Split 7.Renovate			Fract. Acre	Acres/Sites				34.Softwood F&O	
2.Related 5.Partial 8.Other			21.Base 1 (Fract)	23	0.10	100	%	0	
3.Distress 6.Exempt 9.Short			22.Base 2 (Fract)	52	57.80	100	%	0	
Verified 1 Buyer			23.Base 3					%	
1.Buyer 4.Agent 7.Family			Acres					%	
2.Seller 5.Pub Rec 8.Other			24.Base 1					%	
3.Lender 6.MLS 9.			25.Base 2					%	
			26.Frontage 1					%	
			27.Rear Land 4					%	
			28.Rear Land 1					%	
			29.Rear Land 2					%	
			Total Acreage		0.10				44.Lot Improvemen
									45.Subdivision Lo
									46.Golf Course

Bowdoin

Map Lot 05-33-02

Account 502

Location LITCHFIELD RD

Card 1 Of 1 7/19/2022

Building Style 0 Not Coded	SF Bsmt Living 0	Layout 0
0.Not Code 4.Cape 8.Log	Fin Bsmt Grade 0 0	1.Typical 4. 7.
1.Conv. 5.Garrison 9.Other	OCCUPANCY 0	2.Inadeq 5. 8.
2.Ranch 6.Split 10.DW	Heat Type 100% 0 Not Coded	3.Poor 6. 9.
3.R Ranch 7.Contemp 11.Church	0.Not Code 4.Steam 8.FI/Wall	Attic 0
Dwelling Units 0	1.HWBB 5.FWA 9.No Heat	1.1/4 Fin 4.Full Fin 7.
Other Units 0	2.HWCI 6.GravWA 11.	2.1/2 Fin 5.FI/Stair 8.
Stories 0	3.H Pump 7.Electric 12.	3.3/4 Fin 6. 9.None
1.1 4.1.5 7.4	Cool Type 0% 9 None	Insulation 0
2.2 5.1.75 8.20	1.Refrig 4.W&C Air 7.	1.Full 4.Minimal 7.
3.3 6.2.5 9.Yurt	2.Evapor 5. 8.	2.Heavy 5. 8.
Exterior Walls 0 Not Coded	3.H Pump 6. 9.None	3.Capped 6. 9.None
0.Not Code 4.Asbestos 8.Concrete	Kitchen Style 0	Unfinished % 0%
1.Wood 5.Stucco 9.Other	1.Modern 4.Obsolete 7.	Grade & Factor 0 0%
2.Vin/Al 6.Brick 10.Board B	2.Typical 5. 8.	1.E Grade 4.B Grade 7.
3.Compos. 7.Stone 12.	3.Old Type 6. 9.None	2.D Grade 5.A Grade 8.
Roof Surface 0	Bath(s) Style 0	3.C Grade 6.AA Grade 9.Same
1.Asphalt 4.Composit 7.	1.Modern 4.Obsolete 7.	SQFT (Footprint) 0
2.Slate 5.Wood 8.	2.Typical 5. 8.	Condition 0
3.Metal 6.Other 9.	3.Old Type 6. 9.None	1.Poor 4.Avg 7.V G
SF Masonry Trim 0	# Rooms 0	2.Fair 5.Avg+ 8.Exc
SEPTIC DESIGN 0	# Bedrooms 0	3.Avg- 6.Good 9.Same
BLDG PERMIT 0	# Full Baths 0	Phys. % Good 0%
Year Built 0	# Half Baths 0	Funct. % Good 100%
Year Remodeled 0	# Addn Fixtures 0	Functional Code 9 None
Foundation 0	# Fireplaces 0	1.Incomp 4.Delap 7.No Power
1.Concrete 4.Wood 7.		2.O-Built 5.Bsmt 8.LongTerm
2.C Block 5.Slab 8.		3.Damage 6.Dbwd 9.None
3.Br/Stone 6.Piers 9.		Econ. % Good 100%
Basement 0		Economic Code None
1.1/4 Bmt 4.Full Bmt 7.		0.None 3.No Power 7.
2.1/2 Bmt 5.None 8.		1.Location 4.Generate 8.
3.3/4 Bmt 6. 9.None		2.Encroach 9.None 9.
Bsmt Gar # Cars 0		Entrance Code 3 Information Only
Wet Basement 0		1.Interior 4.Vacant 7.Entered
1.Dry 4. 7.		2.Refusal 5.Estimate 8.No
2.Damp 5. 8.		3.Informed 6.Reviewed 9.Land
3.Wet 6. 9.		Information Code 4 Agent
		1.Owner 4.Agent 7.
		2.Relative 5.Estimate 8.
		3.Tenant 6.Other 9.



Date Inspected

Additions, Outbuildings & Improvements							
Type	Year	Units	Grade	Cond	Phys.	Funct.	Sound Value
					%	%	1.One Story Fram
					%	%	2.Two Story Fram
					%	%	3.Three Story Fr
					%	%	4.1 & 1/2 Story
					%	%	5.1 & 3/4 Story
					%	%	6.2 & 1/2 Story
					%	%	21.Open Frame Por
					%	%	22.Encl Frame Por
					%	%	23.Attached Garag
					%	%	24.Frame Shed
					%	%	25.Frame Bay Wind
					%	%	26.1SFr Overhang
					%	%	27.Unfin Basement
					%	%	28.Unfinished Att
					%	%	29.Finished Attic

SAWYER, BEVERLY R
65 LITCHFIELD RD
BOWDOIN ME 04287

B1278P347

Inspection Witnessed By:

X

Date

No./Date	Description	Date Insp.

Notes:

Bowdoin

Property Data				Assessment Record									
Neighborhood 5 Map 5			Year	Land	Buildings	Exempt	Total						
Tree Growth Year 0			2009	49,560	0	0	49,560						
Farmland Yr 0			2010	49,560	0	0	49,560						
Open Space Yr 0			2011	49,560	0	0	49,560						
Zone/Land Use 11 Residential 1			2012	49,560	0	0	49,560						
Secondary Zone			2013	49,560	0	0	49,560						
Topography			2014	49,560	0	0	49,560						
1.Level 4.Below St 7.LevelBog			2015	49,560	0	0	49,560						
2.Rolling 5.Low 8.Conform			2016	49,560	0	0	49,560						
3.Above St 6.FZone 9.Non-Confor			2017	49,560	0	0	49,560						
Utilities			2018	49,560	0	0	49,560						
1.Public 4.Dr Well 7.Cesspool			2019	49,560	0	0	49,560						
2.Water 5.Dug Well 8.			2020	49,560	0	0	49,560						
3.Sewer 6.Septic 9.None			2021	49,560	0	0	49,560						
Street 1 Paved			2022	49,560	0	0	49,560						
1.Paved 4.Proposed 7.MHG			Land Data										
2.Semi Imp 5.R/O/W 8.DIS			Front Foot	Type	Effective		Influence		Influence Codes				
3.Gravel 6.MHP 9.None					Frontage	Depth	Factor	Code					
TG PLAN YEAR 0													
Tif District # 0			11.Road Frontage				%	1.Unimproved					
Sale Data			12.Delta Triangle				%	2.Excess Frtg					
Sale Date			13.Nabla Triangle				%	3.Topography					
Price			14.Rear Land				%	4.Size/Shape					
Sale Type			15.Miscellaneous				%	5.Access					
1.Land 4.Mobile 7.C/I L&B			Square Foot	Square Feet									
2.L & B 5.Other 8.													
3.Building 6.C/I Land 9.													
Financing													
1.Convent 4.Seller 7.													
2.FHA/VA 5.Private 8.													
3.Assumed 6.Cash 9.Unknown													
Validity								Fract. Acre		Acres/Sites			
1.Valid 4.Split 7.Renovate								21.Base 1 (Fract)	24	1.00	100		%
2.Related 5.Partial 8.Other			22.Base 2 (Fract)	28	1.47	100	%	0					
3.Distress 6.Exempt 9.Short			23.Base 3	44	1.00	100	%	0					
Verified			Acres		Acres/Sites		Total Acreage 2.47						
1.Buyer 4.Agent 7.Family			24.Base 1							%			
2.Seller 5.Pub Rec 8.Other			25.Base 2							%			
3.Lender 6.MLS 9.			26.Frontage 1							%			
			27.Rear Land 4							%			
			28.Rear Land 1							%			
			29.Rear Land 2							%			

46.Golf Course

Bowdoin

Map Lot 05-34-0

Account 505

Location 65 LITCHFIELD RD

Card 1 Of 1 7/19/2022

Building Style 0 Not Coded	SF Bsmt Living 0	Layout 0
0.Not Code 4.Cape 8.Log	Fin Bsmt Grade 0 0	1.Typical 4. 7.
1.Conv. 5.Garrison 9.Other	OCCUPANCY 0	2.Inadeq 5. 8.
2.Ranch 6.Split 10.DW	Heat Type 100% 0 Not Coded	3.Poor 6. 9.
3.R Ranch 7.Contemp 11.Church	0.Not Code 4.Steam 8.FI/Wall	Attic 0
Dwelling Units 0	1.HWBB 5.FWA 9.No Heat	1.1/4 Fin 4.Full Fin 7.
Other Units 0	2.HWCI 6.GravWA 11.	2.1/2 Fin 5.FI/Stair 8.
Stories 0	3.H Pump 7.Electric 12.	3.3/4 Fin 6. 9.None
1.1 4.1.5 7.4	Cool Type 0% 9 None	Insulation 0
2.2 5.1.75 8.20	1.Refrig 4.W&C Air 7.	1.Full 4.Minimal 7.
3.3 6.2.5 9.Yurt	2.Evapor 5. 8.	2.Heavy 5. 8.
Exterior Walls 0 Not Coded	3.H Pump 6. 9.None	3.Capped 6. 9.None
0.Not Code 4.Asbestos 8.Concrete	Kitchen Style 0	Unfinished % 0%
1.Wood 5.Stucco 9.Other	1.Modern 4.Obsolete 7.	Grade & Factor 0 0%
2.Vin/Al 6.Brick 10.Board B	2.Typical 5. 8.	1.E Grade 4.B Grade 7.
3.Compos. 7.Stone 12.	3.Old Type 6. 9.None	2.D Grade 5.A Grade 8.
Roof Surface 0	Bath(s) Style 0	3.C Grade 6.AA Grade 9.Same
1.Asphalt 4.Composit 7.	1.Modern 4.Obsolete 7.	SQFT (Footprint) 0
2.Slate 5.Wood 8.	2.Typical 5. 8.	Condition 0
3.Metal 6.Other 9.	3.Old Type 6. 9.None	1.Poor 4.Avg 7.V G
SF Masonry Trim 0	# Rooms 0	2.Fair 5.Avg+ 8.Exc
SEPTIC DESIGN 0	# Bedrooms 0	3.Avg- 6.Good 9.Same
BLDG PERMIT 0	# Full Baths 0	Phys. % Good 0%
Year Built 0	# Half Baths 0	Funct. % Good 100%
Year Remodeled 0	# Addn Fixtures 0	Functional Code 9 None
Foundation 0	# Fireplaces 0	1.Incomp 4.Delap 7.No Power
1.Concrete 4.Wood 7.		2.O-Built 5.Bsmt 8.LongTerm
2.C Block 5.Slab 8.		3.Damage 6.Dbwd 9.None
3.Br/Stone 6.Piers 9.		Econ. % Good 100%
Basement 0		Economic Code None
1.1/4 Bmt 4.Full Bmt 7.		0.None 3.No Power 7.
2.1/2 Bmt 5.None 8.		1.Location 4.Generate 8.
3.3/4 Bmt 6. 9.None		2.Encroach 9.None 9.
Bsmt Gar # Cars 0		Entrance Code 0
Wet Basement 0		1.Interior 4.Vacant 7.Entered
1.Dry 4. 7.		2.Refusal 5.Estimate 8.No
2.Damp 5. 8.	3.Informed 6.Reviewed 9.Land	
3.Wet 6. 9.	Information Code 0	
	1.Owner 4.Agent 7.	
	2.Relative 5.Estimate 8.	
	3.Tenant 6.Other 9.	

Date Inspected

Additions, Outbuildings & Improvements							
Type	Year	Units	Grade	Cond	Phys.	Funct.	Sound Value
					%	%	1.One Story Fram
					%	%	2.Two Story Fram
					%	%	3.Three Story Fr
					%	%	4.1 & 1/2 Story
					%	%	5.1 & 3/4 Story
					%	%	6.2 & 1/2 Story
					%	%	21.Open Frame Por
					%	%	22.Encl Frame Por
					%	%	23.Attached Garag
					%	%	24.Frame Shed
					%	%	25.Frame Bay Wind
					%	%	26.1SFr Overhang
					%	%	27.Unfin Basement
					%	%	28.Unfinished Att
					%	%	29.Finished Attic

LETOURNEAU, KATHY A
45 LITCHFIELD RD
BOWDOIN ME 04287

B899P326

Inspection Witnessed By:

X

Date

No./Date	Description	Date Insp.

Notes:

Bowdoin

Property Data			Assessment Record						
Neighborhood 5 Map 5			Year	Land	Buildings	Exempt	Total		
Tree Growth Year 0			2009	50,800	60,200	13,000	98,000		
Farmland Yr 0			2010	50,800	60,200	10,000	101,000		
Open Space Yr 0			2011	50,800	60,200	10,000	101,000		
Zone/Land Use 11 Residential 1			2012	50,800	61,750	10,000	102,550		
Secondary Zone			2013	50,800	61,750	10,000	102,550		
Topography			2014	50,800	61,750	10,000	102,550		
1.Level 4.Below St 7.LevelBog			2015	50,800	61,750	10,000	102,550		
2.Rolling 5.Low 8.Conform			2016	50,800	61,750	15,000	97,550		
3.Above St 6.FZone 9.Non-Confor			2017	50,800	61,750	20,000	92,550		
Utilities			2018	50,800	61,750	20,000	92,550		
1.Public 4.Dr Well 7.Cesspool			2019	50,800	61,750	20,000	92,550		
2.Water 5.Dug Well 8.			2020	50,800	61,750	25,000	87,550		
3.Sewer 6.Septic 9.None			2021	50,800	61,750	25,000	87,550		
Street 1 Paved			2022	50,800	55,780	21,500	85,080		
1.Paved 4.Proposed 7.MHG			Land Data						
2.Semi Imp 5.R/O/W 8.DIS									
3.Gravel 6.MHP 9.None			Front Foot	Type	Effective		Influence		Influence Codes
TG PLAN YEAR 0			11.Road Frontage		Frontage	Depth	Factor	Code	
Tif District # 0			12.Delta Triangle				%		1.Unimproved
Sale Data			13.Nabla Triangle				%		2.Excess Frtg
Sale Date			14.Rear Land				%		3.Topography
Price			15.Miscellaneous				%		4.Size/Shape
Sale Type							%		5.Access
1.Land 4.Mobile 7.C/I L&B							%		6.Restriction
2.L & B 5.Other 8.			Square Foot	Square Feet					7.Open Space
3.Building 6.C/I Land 9.			16.Regular Lot				%		8.View/Environ
Financing			17.Secondary Lot				%		9.Fract Share
1.Convent 4.Seller 7.			18.Hydro Facility				%		Acres
2.FHA/VA 5.Private 8.			19.Improvements				%		30.Rear Land 3
3.Assumed 6.Cash 9.Unknown			20.Base 3 (Fract)				%		31.Tillable
Validity			Fract. Acre	Acres/Sites					32.Pasture
1.Valid 4.Split 7.Renovate			21.Base 1 (Fract)	24	1.00	100	%	0	33.Orchard
2.Related 5.Partial 8.Other			22.Base 2 (Fract)	26	1.10	100	%	0	34.Softwood F&O
3.Distress 6.Exempt 9.Short			23.Base 3	44	1.00	100	%	0	35.Mixed Wood F&O
Verified			Acres				%		36.Hardwood F&O
1.Buyer 4.Agent 7.Family			24.Base 1				%		37.Softwood TG
2.Seller 5.Pub Rec 8.Other			25.Base 2				%		38.Mixed Wood TG
3.Lender 6.MLS 9.			26.Frontage 1				%		39.Hardwood TG
			27.Rear Land 4				%		40.Wasteland
			28.Rear Land 1				%		41.Commercial
			29.Rear Land 2				%		42.2nd Site
			Total Acreage		2.10				43.Post Rd
									44.Lot Improvemen
									45.Subdivision Lo
									46.Golf Course

Bowdoin

Map Lot 05-34-01

Account 506

Location 45 LITCHFIELD RD

Card 1 Of 1 7/19/2022

Building Style 2 Ranch 0.Not Code 4.Cape 8.Log 1.Conv. 5.Garrison 9.Other 2.Ranch 6.Split 10.DW 3.R Ranch 7.Contemp 11.Church	SF Bsmt Living 0 Fin Bsmt Grade 0 0 OCCUPANCY 0 Heat Type 100% 5 Forced Warm Air 0.Not Code 4.Steam 8.FI/Wall 1.HWBB 5.FWA 9.No Heat 2.HWCI 6.GravWA 11. 3.H Pump 7.Electric 12.	Layout 1 Typical 1.Typical 4. 7. 2.Inadeq 5. 8. 3.Poor 6. 9. Attic 9 None 1.1/4 Fin 4.Full Fin 7. 2.1/2 Fin 5.FI/Stair 8. 3.3/4 Fin 6. 9.None		
Dwelling Units 1 Other Units 0 Stories 1 One Story 1.1 4.1.5 7.4 2.2 5.1.75 8.20 3.3 6.2.5 9.Yurt	Cool Type 0% 9 None 1.Refrig 4.W&C Air 7. 2.Evapor 5. 8. 3.H Pump 6. 9.None	Insulation 1 Full 1.Full 4.Minimal 7. 2.Heavy 5. 8. 3.Capped 6. 9.None		
Exterior Walls 1 Wood Siding 0.Not Code 4.Asbestos 8.Concrete 1.Wood 5.Stucco 9.Other 2.Vin/Al 6.Brick 10.Board B 3.Compos. 7.Stone 12.	Kitchen Style 2 Typical 1.Modern 4.Obsolete 7. 2.Typical 5. 8. 3.Old Type 6. 9.None	Unfinished % 0% Grade & Factor 3 Average 100% 1.E Grade 4.B Grade 7. 2.D Grade 5.A Grade 8. 3.C Grade 6.AA Grade 9.Same		
Roof Surface 1 Asphalt Shingles 1.Asphalt 4.Composit 7. 2.Slate 5.Wood 8. 3.Metal 6.Other 9.	Bath(s) Style 2 Typical Bath(s) 1.Modern 4.Obsolete 7. 2.Typical 5. 8. 3.Old Type 6. 9.None	SQFT (Footprint) 768 Condition 3 Below Average 1.Poor 4.Avg 7.V G 2.Fair 5.Avg+ 8.Exc 3.Avg- 6.Good 9.Same		
SF Masonry Trim 0 SEPTIC DESIGN 0 BLDG PERMIT 0 Year Built 1974 Year Remodeled 0	# Rooms 6 # Bedrooms 2 # Full Baths 1 # Half Baths 0 # Addn Fixtures 0 # Fireplaces 1	Phys. % Good 0% Funct. % Good 100% Functional Code 9 None 1.Incomp 4.Delap 7.No Power 2.O-Built 5.Bsmt 8.LongTerm 3.Damage 6.Dbwd 9.None		
Foundation 1 Concrete 1.Concrete 4.Wood 7. 2.C Block 5.Slab 8. 3.Br/Stone 6.Piers 9.		Econ. % Good 100% Economic Code None 0.None 3.No Power 7. 1.Location 4.Generate 8. 2.Encroach 9.None 9.		
Basement 4 Full Basement 1.1/4 Bmt 4.Full Bmt 7. 2.1/2 Bmt 5.None 8. 3.3/4 Bmt 6. 9.None		Entrance Code 5 Estimated 1.Interior 4.Vacant 7.Entered 2.Refusal 5.Estimate 8.No 3.Informed 6.Reviewed 9.Land		
Bsmt Gar # Cars 0 Wet Basement 1 Dry Basement 1.Dry 4. 7. 2.Damp 5. 8. 3.Wet 6. 9.		Information Code 6 Other 1.Owner 4.Agent 7. 2.Relative 5.Estimate 8. 3.Tenant 6.Other 9.		

Date Inspected 4/04/2012

Additions, Outbuildings & Improvements

Type	Year	Units	Grade	Cond	Phys.	Funct.	Sound Value
25 Frame Bay	0	8	0 0	0	0 %	0 %	
25 Frame Bay	0	8	0 0	0	0 %	0 %	
68 Wood Deck	0	384	0 0	0	0 %	0 %	
24 Frame Shed	2000	192	2 100	2	0 %	100 %	
24 Frame Shed	1974				%	%	500
					%	%	
					%	%	
					%	%	
					%	%	
					%	%	

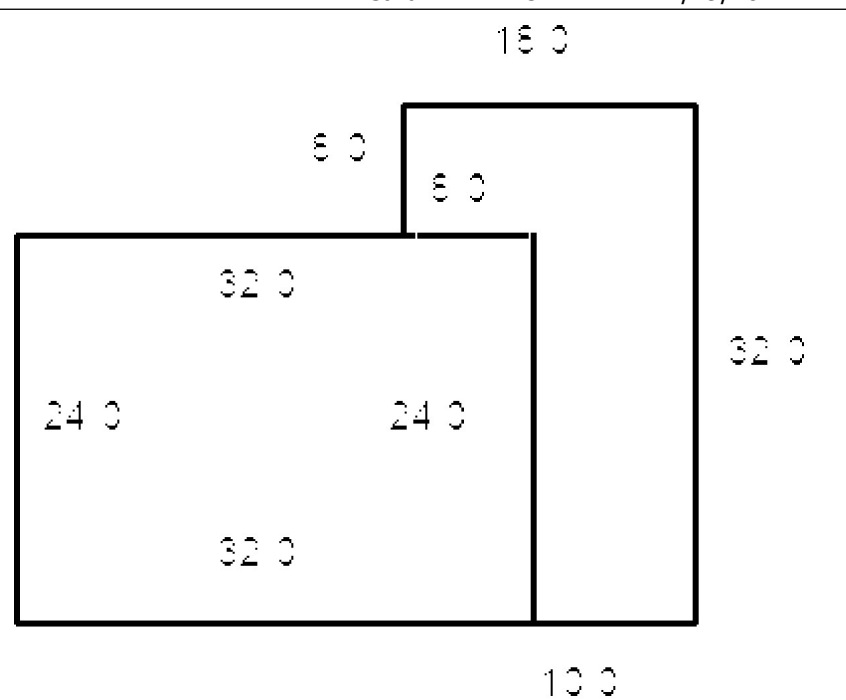

JOHNSTON, TOBY
55 LITCHFIELD RD
BOWDOIN ME 04287

Previous Owner
DRISCOLL, MICHAEL
55 LITCHFIELD RD

BOWDOIN ME 04287
Sale Date: 5/04/2009

Inspection Witnessed By:

X	Date	Date Insp.
No./Date	Description	Date Insp.

Notes:

Bowdoin

Property Data			Assessment Record																																																																																																																																																																																																												
Neighborhood 5 Map 5			Year	Land	Buildings	Exempt	Total																																																																																																																																																																																																								
Tree Growth Year 0			2009	0	13,860	0	13,860																																																																																																																																																																																																								
Farmland Yr 0			2010	0	13,860	0	13,860																																																																																																																																																																																																								
Open Space Yr 0			2011	0	13,860	0	13,860																																																																																																																																																																																																								
Zone/Land Use 11 Residential 1			2012	0	13,860	0	13,860																																																																																																																																																																																																								
Secondary Zone			2013	0	13,860	0	13,860																																																																																																																																																																																																								
Topography			2014	0	13,860	0	13,860																																																																																																																																																																																																								
1.Level 4.Below St 7.LevelBog			2015	0	13,860	0	13,860																																																																																																																																																																																																								
2.Rolling 5.Low 8.Conform			2016	0	13,860	0	13,860																																																																																																																																																																																																								
3.Above St 6.FZone 9.Non-Confor			2017	0	13,860	0	13,860																																																																																																																																																																																																								
Utilities			2018	0	13,860	0	13,860																																																																																																																																																																																																								
1.Public 4.Dr Well 7.Cesspool			2019	0	13,860	0	13,860																																																																																																																																																																																																								
2.Water 5.Dug Well 8.			2020	0	13,860	0	13,860																																																																																																																																																																																																								
3.Sewer 6.Septic 9.None			2021	0	13,860	0	13,860																																																																																																																																																																																																								
Street 1 Paved			2022	0	13,860	0	13,860																																																																																																																																																																																																								
1.Paved 4.Proposed 7.MHG			Land Data																																																																																																																																																																																																												
2.Semi Imp 5.R/O/W 8.DIS																																																																																																																																																																																																															
3.Gravel 6.MHP 9.None			<table border="1"> <thead> <tr> <th rowspan="2">Front Foot</th> <th rowspan="2">Type</th> <th colspan="2">Effective</th> <th colspan="2">Influence</th> <th rowspan="2">Influence Codes</th> </tr> <tr> <th>Frontage</th> <th>Depth</th> <th>Factor</th> <th>Code</th> </tr> </thead> <tbody> <tr> <td>11.Road Frontage</td> <td></td> <td></td> <td></td> <td>%</td> <td></td> <td>1.Unimproved</td> </tr> <tr> <td>12.Delta Triangle</td> <td></td> <td></td> <td></td> <td>%</td> <td></td> <td>2.Excess Frtg</td> </tr> <tr> <td>13.Nabla Triangle</td> <td></td> <td></td> <td></td> <td>%</td> <td></td> <td>3.Topography</td> </tr> <tr> <td>14.Rear Land</td> <td></td> <td></td> <td></td> <td>%</td> <td></td> <td>4.Size/Shape</td> </tr> <tr> <td>15.Miscellaneous</td> <td></td> <td></td> <td></td> <td>%</td> <td></td> <td>5.Access</td> </tr> <tr> <td></td> <td></td> <td></td> <td></td> <td>%</td> <td></td> <td>6.Restriction</td> </tr> <tr> <td></td> <td></td> <td></td> <td></td> <td>%</td> <td></td> <td>7.Open Space</td> </tr> <tr> <td></td> <td></td> <td></td> <td></td> <td>%</td> <td></td> <td>8.View/Environ</td> </tr> <tr> <td></td> <td></td> <td></td> <td></td> <td>%</td> <td></td> <td>9.Fract Share</td> </tr> <tr> <td></td> <td></td> <td></td> <td></td> <td>%</td> <td></td> <td>Acres</td> </tr> <tr> <td></td> <td></td> <td></td> <td></td> <td>%</td> <td></td> <td>30.Rear Land 3</td> </tr> <tr> <td></td> <td></td> <td></td> <td></td> <td>%</td> <td></td> <td>31.Tillable</td> </tr> <tr> <td></td> <td></td> <td></td> <td></td> <td>%</td> <td></td> <td>32.Pasture</td> </tr> <tr> <td></td> <td></td> <td></td> <td></td> <td>%</td> <td></td> <td>33.Orchard</td> </tr> <tr> <td></td> <td></td> <td></td> <td></td> <td>%</td> <td></td> <td>34.Softwood F&O</td> </tr> <tr> <td></td> <td></td> <td></td> <td></td> <td>%</td> <td></td> <td>35.Mixed Wood F&O</td> </tr> <tr> <td></td> <td></td> <td></td> <td></td> <td>%</td> <td></td> <td>36.Hardwood F&O</td> </tr> <tr> <td></td> <td></td> <td></td> <td></td> <td>%</td> <td></td> <td>37.Softwood TG</td> </tr> <tr> <td></td> <td></td> <td></td> <td></td> <td>%</td> <td></td> <td>38.Mixed Wood TG</td> </tr> <tr> <td></td> <td></td> <td></td> <td></td> <td>%</td> <td></td> <td>39.Hardwood TG</td> </tr> <tr> <td></td> <td></td> <td></td> <td></td> <td>%</td> <td></td> <td>40.Wasteland</td> </tr> <tr> <td></td> <td></td> <td></td> <td></td> <td>%</td> <td></td> <td>41.Commercial</td> </tr> <tr> <td></td> <td></td> <td></td> <td></td> <td>%</td> <td></td> <td>42.2nd Site</td> </tr> <tr> <td></td> <td></td> <td></td> <td></td> <td>%</td> <td></td> <td>43.Post Rd</td> </tr> <tr> <td></td> <td></td> <td></td> <td></td> <td>%</td> <td></td> <td>44.Lot Improvemen</td> </tr> <tr> <td></td> <td></td> <td></td> <td></td> <td>%</td> <td></td> <td>45.Subdivision Lo</td> </tr> <tr> <td></td> <td></td> <td></td> <td></td> <td>%</td> <td></td> <td>46.Golf Course</td> </tr> </tbody> </table>					Front Foot	Type	Effective		Influence		Influence Codes	Frontage	Depth	Factor	Code	11.Road Frontage				%		1.Unimproved	12.Delta Triangle				%		2.Excess Frtg	13.Nabla Triangle				%		3.Topography	14.Rear Land				%		4.Size/Shape	15.Miscellaneous				%		5.Access					%		6.Restriction					%		7.Open Space					%		8.View/Environ					%		9.Fract Share					%		Acres					%		30.Rear Land 3					%		31.Tillable					%		32.Pasture					%		33.Orchard					%		34.Softwood F&O					%		35.Mixed Wood F&O					%		36.Hardwood F&O					%		37.Softwood TG					%		38.Mixed Wood TG					%		39.Hardwood TG					%		40.Wasteland					%		41.Commercial					%		42.2nd Site					%		43.Post Rd					%		44.Lot Improvemen					%		45.Subdivision Lo					%		46.Golf Course
Front Foot	Type	Effective								Influence		Influence Codes																																																																																																																																																																																																			
		Frontage	Depth	Factor	Code																																																																																																																																																																																																										
11.Road Frontage				%		1.Unimproved																																																																																																																																																																																																									
12.Delta Triangle				%		2.Excess Frtg																																																																																																																																																																																																									
13.Nabla Triangle				%		3.Topography																																																																																																																																																																																																									
14.Rear Land				%		4.Size/Shape																																																																																																																																																																																																									
15.Miscellaneous				%		5.Access																																																																																																																																																																																																									
				%		6.Restriction																																																																																																																																																																																																									
				%		7.Open Space																																																																																																																																																																																																									
				%		8.View/Environ																																																																																																																																																																																																									
				%		9.Fract Share																																																																																																																																																																																																									
				%		Acres																																																																																																																																																																																																									
				%		30.Rear Land 3																																																																																																																																																																																																									
				%		31.Tillable																																																																																																																																																																																																									
				%		32.Pasture																																																																																																																																																																																																									
				%		33.Orchard																																																																																																																																																																																																									
				%		34.Softwood F&O																																																																																																																																																																																																									
				%		35.Mixed Wood F&O																																																																																																																																																																																																									
				%		36.Hardwood F&O																																																																																																																																																																																																									
				%		37.Softwood TG																																																																																																																																																																																																									
				%		38.Mixed Wood TG																																																																																																																																																																																																									
				%		39.Hardwood TG																																																																																																																																																																																																									
				%		40.Wasteland																																																																																																																																																																																																									
				%		41.Commercial																																																																																																																																																																																																									
				%		42.2nd Site																																																																																																																																																																																																									
				%		43.Post Rd																																																																																																																																																																																																									
				%		44.Lot Improvemen																																																																																																																																																																																																									
				%		45.Subdivision Lo																																																																																																																																																																																																									
				%		46.Golf Course																																																																																																																																																																																																									
TG PLAN YEAR 0			<table border="1"> <thead> <tr> <th>Fract. Acre</th> <th colspan="2">Acreage/Sites</th> </tr> </thead> <tbody> <tr> <td>21.Base 1 (Fract)</td> <td></td> <td>%</td> </tr> <tr> <td>22.Base 2 (Fract)</td> <td></td> <td>%</td> </tr> <tr> <td>23.Base 3</td> <td></td> <td>%</td> </tr> <tr> <td>Acres</td> <td></td> <td>%</td> </tr> <tr> <td>24.Base 1</td> <td></td> <td>%</td> </tr> <tr> <td>25.Base 2</td> <td></td> <td>%</td> </tr> <tr> <td>26.Frontage 1</td> <td></td> <td>%</td> </tr> <tr> <td>27.Rear Land 4</td> <td></td> <td>%</td> </tr> <tr> <td>28.Rear Land 1</td> <td></td> <td>%</td> </tr> <tr> <td>29.Rear Land 2</td> <td></td> <td>%</td> </tr> <tr> <td colspan="2">Total Acreage</td> <td>0.00</td> </tr> </tbody> </table>					Fract. Acre	Acreage/Sites		21.Base 1 (Fract)		%	22.Base 2 (Fract)		%	23.Base 3		%	Acres		%	24.Base 1		%	25.Base 2		%	26.Frontage 1		%	27.Rear Land 4		%	28.Rear Land 1		%	29.Rear Land 2		%	Total Acreage		0.00																																																																																																																																																																				
Fract. Acre	Acreage/Sites																																																																																																																																																																																																														
21.Base 1 (Fract)		%																																																																																																																																																																																																													
22.Base 2 (Fract)		%																																																																																																																																																																																																													
23.Base 3		%																																																																																																																																																																																																													
Acres		%																																																																																																																																																																																																													
24.Base 1		%																																																																																																																																																																																																													
25.Base 2		%																																																																																																																																																																																																													
26.Frontage 1		%																																																																																																																																																																																																													
27.Rear Land 4		%																																																																																																																																																																																																													
28.Rear Land 1		%																																																																																																																																																																																																													
29.Rear Land 2		%																																																																																																																																																																																																													
Total Acreage		0.00																																																																																																																																																																																																													
Tif District # 0			<table border="1"> <thead> <tr> <th colspan="3">Sale Data</th> </tr> </thead> <tbody> <tr> <td>Sale Date</td> <td colspan="2">5/04/2009</td> </tr> <tr> <td>Price</td> <td colspan="2"></td> </tr> <tr> <td>Sale Type 4 Mobile Home</td> <td colspan="2"></td> </tr> <tr> <td>1.Land 4.Mobile 7.C/I L&B</td> <td colspan="2"></td> </tr> <tr> <td>2.L & B 5.Other 8.</td> <td colspan="2"></td> </tr> <tr> <td>3.Building 6.C/I Land 9.</td> <td colspan="2"></td> </tr> <tr> <td>Financing 1 Conventional</td> <td colspan="2"></td> </tr> <tr> <td>1.Convent 4.Seller 7.</td> <td colspan="2"></td> </tr> <tr> <td>2.FHA/VA 5.Private 8.</td> <td colspan="2"></td> </tr> <tr> <td>3.Assumed 6.Cash 9.Unknown</td> <td colspan="2"></td> </tr> <tr> <td>Validity 8 Other Non Valid</td> <td colspan="2"></td> </tr> <tr> <td>1.Valid 4.Split 7.Renovate</td> <td colspan="2"></td> </tr> <tr> <td>2.Related 5.Partial 8.Other</td> <td colspan="2"></td> </tr> <tr> <td>3.Distress 6.Exempt 9.Short</td> <td colspan="2"></td> </tr> <tr> <td>Verified 1 Buyer</td> <td colspan="2"></td> </tr> <tr> <td>1.Buyer 4.Agent 7.Family</td> <td colspan="2"></td> </tr> <tr> <td>2.Seller 5.Pub Rec 8.Other</td> <td colspan="2"></td> </tr> <tr> <td>3.Lender 6.MLS 9.</td> <td colspan="2"></td> </tr> </tbody> </table>					Sale Data			Sale Date	5/04/2009		Price			Sale Type 4 Mobile Home			1.Land 4.Mobile 7.C/I L&B			2.L & B 5.Other 8.			3.Building 6.C/I Land 9.			Financing 1 Conventional			1.Convent 4.Seller 7.			2.FHA/VA 5.Private 8.			3.Assumed 6.Cash 9.Unknown			Validity 8 Other Non Valid			1.Valid 4.Split 7.Renovate			2.Related 5.Partial 8.Other			3.Distress 6.Exempt 9.Short			Verified 1 Buyer			1.Buyer 4.Agent 7.Family			2.Seller 5.Pub Rec 8.Other			3.Lender 6.MLS 9.																																																																																																																																																	
Sale Data																																																																																																																																																																																																															
Sale Date	5/04/2009																																																																																																																																																																																																														
Price																																																																																																																																																																																																															
Sale Type 4 Mobile Home																																																																																																																																																																																																															
1.Land 4.Mobile 7.C/I L&B																																																																																																																																																																																																															
2.L & B 5.Other 8.																																																																																																																																																																																																															
3.Building 6.C/I Land 9.																																																																																																																																																																																																															
Financing 1 Conventional																																																																																																																																																																																																															
1.Convent 4.Seller 7.																																																																																																																																																																																																															
2.FHA/VA 5.Private 8.																																																																																																																																																																																																															
3.Assumed 6.Cash 9.Unknown																																																																																																																																																																																																															
Validity 8 Other Non Valid																																																																																																																																																																																																															
1.Valid 4.Split 7.Renovate																																																																																																																																																																																																															
2.Related 5.Partial 8.Other																																																																																																																																																																																																															
3.Distress 6.Exempt 9.Short																																																																																																																																																																																																															
Verified 1 Buyer																																																																																																																																																																																																															
1.Buyer 4.Agent 7.Family																																																																																																																																																																																																															
2.Seller 5.Pub Rec 8.Other																																																																																																																																																																																																															
3.Lender 6.MLS 9.																																																																																																																																																																																																															

Bowdoin

Map Lot 05-34-A

Account 508

Location 55 LITCHFIELD RD

Card 1 Of 1 7/19/2022

Building Style 0 Not Coded 0.Not Code 4.Cape 8.Log 1.Conv. 5.Garrison 9.Other 2.Ranch 6.Split 10.DW 3.R Ranch 7.Contemp 11.Church Dwelling Units 0 Other Units 0 Stories 0 1.1 4.1.5 7.4 2.2 5.1.75 8.20 3.3 6.2.5 9.Yurt Exterior Walls 0 Not Coded 0.Not Code 4.Asbestos 8.Concrete 1.Wood 5.Stucco 9.Other 2.Vin/Al 6.Brick 10.Board B 3.Compos. 7.Stone 12. Roof Surface 0 1.Asphalt 4.Composit 7. 2.Slate 5.Wood 8. 3.Metal 6.Other 9. SF Masonry Trim 0 SEPTIC DESIGN 0 BLDG PERMIT 0 Year Built 0 Year Remodeled 0 Foundation 0 1.Concrete 4.Wood 7. 2.C Block 5.Slab 8. 3.Br/Stone 6.Piers 9. Basement 0 1.1/4 Bmt 4.Full Bmt 7. 2.1/2 Bmt 5.None 8. 3.3/4 Bmt 6. 9.None Bsmt Gar # Cars 0 Wet Basement 0 1.Dry 4. 7. 2.Damp 5. 8. 3.Wet 6. 9.	SF Bsmt Living 0 Fin Bsmt Grade 0 0 OCCUPANCY 0 Heat Type 100% 0 Not Coded 0.Not Code 4.Steam 8.FI/Wall 1.HWBB 5.FWA 9.No Heat 2.HWCI 6.GravWA 11. 3.H Pump 7.Electric 12. Cool Type 0% 9 None 1.Refrig 4.W&C Air 7. 2.Evapor 5. 8. 3.H Pump 6. 9.None Kitchen Style 0 1.Modern 4.Obsolete 7. 2.Typical 5. 8. 3.Old Type 6. 9.None Bath(s) Style 0 1.Modern 4.Obsolete 7. 2.Typical 5. 8. 3.Old Type 6. 9.None # Rooms 0 # Bedrooms 0 # Full Baths 0 # Half Baths 0 # Addn Fixtures 0 # Fireplaces 0	Layout 0 1.Typical 4. 7. 2.Inadeq 5. 8. 3.Poor 6. 9. Attic 0 1.1/4 Fin 4.Full Fin 7. 2.1/2 Fin 5.FI/Stair 8. 3.3/4 Fin 6. 9.None Insulation 0 1.Full 4.Minimal 7. 2.Heavy 5. 8. 3.Capped 6. 9.None Unfinished % 0% Grade & Factor 0 0% 1.E Grade 4.B Grade 7. 2.D Grade 5.A Grade 8. 3.C Grade 6.AA Grade 9.Same SQFT (Footprint) 0 Condition 0 1.Poor 4.Avg 7.V G 2.Fair 5.Avg+ 8.Exc 3.Avg- 6.Good 9.Same Phys. % Good 0% Funct. % Good 100% Functional Code 9 None 1.Incomp 4.Delap 7.No Power 2.O-Built 5.Bsmt 8.LongTerm 3.Damage 6.Dbwd 9.None Econ. % Good 100% Economic Code None 0.None 3.No Power 7. 1.Location 4.Generate 8. 2.Encroach 9.None 9. Entrance Code 5 Estimated 1.Interior 4.Vacant 7.Entered 2.Refusal 5.Estimate 8.No 3.Informed 6.Reviewed 9.Land Information Code 5 Estimate 1.Owner 4.Agent 7. 2.Relative 5.Estimate 8. 3.Tenant 6.Other 9.
--	--	---

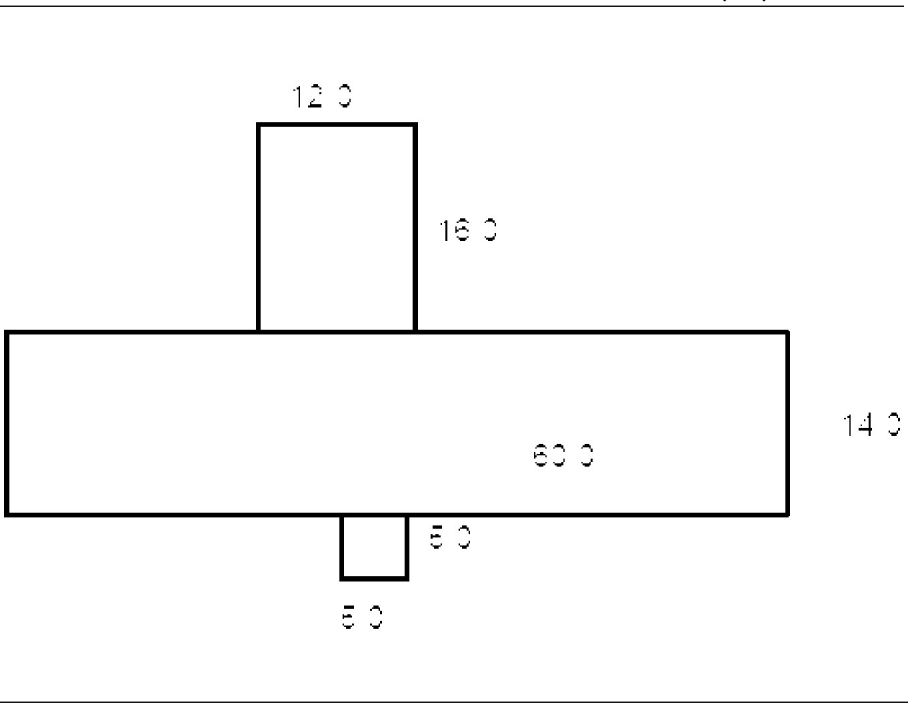

Date Inspected 4/13/2010

Additions, Outbuildings & Improvements

Type	Year	Units	Grade	Cond	Phys.	Funct.	Sound Value
998 14Mobile Home	1986	14x66	3 100	3	0 %	100 %	
					%	%	
					%	%	
					%	%	
					%	%	
					%	%	
					%	%	
					%	%	
					%	%	
					%	%	
					%	%	



BOWDOIN AGGREGATE SALES, INC
 P. O. BOX 308
 BRUNSWICK ME 04011

B1167P165 B2020RP7934

Previous Owner
 LABBE & SONS INC, RAY
 DBA - Bowdoin Aggregate Sales (BAS)
 P. O. Box 308
 BRUNSWICK ME 04011
 Sale Date: 10/13/2020

Property Data			Assessment Record						
Neighborhood 5 Map 5			Year	Land	Buildings	Exempt	Total		
Tree Growth Year 0			2009	174,600	14,580	0	189,180		
Farmland Yr 0			2010	174,600	14,580	0	189,180		
Open Space Yr 0			2011	194,600	14,580	0	209,180		
Zone/Land Use 11 Residential 1			2012	177,600	14,580	0	192,180		
Secondary Zone			2013	177,600	14,580	0	192,180		
Topography			2014	177,600	14,580	0	192,180		
1.Level 4.Below St 7.LevelBog			2015	158,550	14,580	0	173,130		
2.Rolling 5.Low 8.Conform			2016	158,550	14,580	0	173,130		
3.Above St 6.FZone 9.Non-Confor			2017	158,550	14,580	0	173,130		
Utilities			2018	158,550	14,580	0	173,130		
1.Public 4.Dr Well 7.Cesspool			2019	158,550	14,580	0	173,130		
2.Water 5.Dug Well 8.			2020	158,550	30,470	0	189,020		
3.Sewer 6.Septic 9.None			2021	158,550	30,470	0	189,020		
Street 1 Paved			2022	158,550	30,140	0	188,690		
1.Paved 4.Proposed 7.MHG			Land Data						
2.Semi Imp 5.R/O/W 8.DIS									
3.Gravel 6.MHP 9.None			Front Foot	Type	Effective		Influence		Influence Codes
TG PLAN YEAR 0			11.Road Frontage		Frontage	Depth	Factor	Code	
Tif District # 0			12.Delta Triangle						1.Unimproved
Sale Data			13.Nabla Triangle						2.Excess Frtg
Sale Date 10/13/2020			14.Rear Land						3.Topography
Price			15.Miscellaneous						4.Size/Shape
Sale Type 1 Land Only									5.Access
1.Land 4.Mobile 7.C/I L&B									6.Restriction
2.L & B 5.Other 8.			Square Foot	Square Feet					7.Open Space
3.Building 6.C/I Land 9.			16.Regular Lot						8.View/Environ
Financing 9 Unknown			17.Secondary Lot						9.Fract Share
1.Convent 4.Seller 7.			18.Hydro Facility						Acres
2.FHA/VA 5.Private 8.			19.Improvements						30.Rear Land 3
3.Assumed 6.Cash 9.Unknown			20.Base 3 (Fract)						31.Tillable
Validity 8 Other Non Valid									32.Pasture
1.Valid 4.Split 7.Renovate			Fract. Acre	Acres/Sites					33.Orchard
2.Related 5.Partial 8.Other			21.Base 1 (Fract)	28	13.00	100	%	0	34.Softwood F&O
3.Distress 6.Exempt 9.Short			22.Base 2 (Fract)	29	25.00	100	%	0	35.Mixed Wood F&O
Verified 5 Public Record			23.Base 3	47	5.00	100	%	0	36.Hardwood F&O
1.Buyer 4.Agent 7.Family			Acres	30	25.00	100	%	0	37.Softwood TG
2.Seller 5.Pub Rec 8.Other			24.Base 1	27	6.00	100	%	0	38.Mixed Wood TG
3.Lender 6.MLS 9.			25.Base 2	41	1.00	100	%	0	39.Hardwood TG
			26.Frontage 1						40.Wasteland
			27.Rear Land 4						41.Commercial
			28.Rear Land 1						42.2nd Site
			29.Rear Land 2						43.Post Rd
			Total Acreage		74.00				44.Lot Improvemen
									45.Subdivision Lo
									46.Golf Course

Inspection Witnessed By:

X	Date
No./Date	Description
	Date Insp.

Notes:

Bowdoin

Bowdoin

Map Lot 05-35-0

Account 509

Location 109 LITCHFIELD RD

Card 1 Of 1 7/19/2022

Building Style 0 Not Coded	SF Bsmt Living 0	Layout 0
0.Not Code 4.Cape 8.Log	Fin Bsmt Grade 0 0	1.Typical 4. 7.
1.Conv. 5.Garrison 9.Other	OCCUPANCY 0	2.Inadeq 5. 8.
2.Ranch 6.Split 10.DW	Heat Type 100% 0 Not Coded	3.Poor 6. 9.
3.R Ranch 7.Contemp 11.Church	0.Not Code 4.Steam 8.FI/Wall	Attic 0
Dwelling Units 0	1.HWBB 5.FWA 9.No Heat	1.1/4 Fin 4.Full Fin 7.
Other Units 0	2.HWCI 6.GravWA 11.	2.1/2 Fin 5.FI/Stair 8.
Stories 0	3.H Pump 7.Electric 12.	3.3/4 Fin 6. 9.None
1.1 4.1.5 7.4	Cool Type 0% 9 None	Insulation 0
2.2 5.1.75 8.20	1.Refrig 4.W&C Air 7.	1.Full 4.Minimal 7.
3.3 6.2.5 9.Yurt	2.Evapor 5. 8.	2.Heavy 5. 8.
Exterior Walls 0 Not Coded	3.H Pump 6. 9.None	3.Capped 6. 9.None
0.Not Code 4.Asbestos 8.Concrete	Kitchen Style 0	Unfinished % 0%
1.Wood 5.Stucco 9.Other	1.Modern 4.Obsolete 7.	Grade & Factor 0 0%
2.Vin/Al 6.Brick 10.Board B	2.Typical 5. 8.	1.E Grade 4.B Grade 7.
3.Compos. 7.Stone 12.	3.Old Type 6. 9.None	2.D Grade 5.A Grade 8.
Roof Surface 0	Bath(s) Style 0	3.C Grade 6.AA Grade 9.Same
1.Asphalt 4.Composit 7.	1.Modern 4.Obsolete 7.	SQFT (Footprint) 0
2.Slate 5.Wood 8.	2.Typical 5. 8.	Condition 0
3.Metal 6.Other 9.	3.Old Type 6. 9.None	1.Poor 4.Avg 7.V G
SF Masonry Trim 0	# Rooms 0	2.Fair 5.Avg+ 8.Exc
SEPTIC DESIGN 0	# Bedrooms 0	3.Avg- 6.Good 9.Same
BLDG PERMIT 0	# Full Baths 0	Phys. % Good 0%
Year Built 0	# Half Baths 0	Funct. % Good 100%
Year Remodeled 0	# Addn Fixtures 0	Functional Code 9 None
Foundation 0	# Fireplaces 0	1.Incomp 4.Delap 7.No Power
1.Concrete 4.Wood 7.		2.O-Built 5.Bsmt 8.LongTerm
2.C Block 5.Slab 8.		3.Damage 6.Dbwd 9.None
3.Br/Stone 6.Piers 9.		Econ. % Good 100%
Basement 0		Economic Code None
1.1/4 Bmt 4.Full Bmt 7.		0.None 3.No Power 7.
2.1/2 Bmt 5.None 8.		1.Location 4.Generate 8.
3.3/4 Bmt 6. 9.None		2.Encroach 9.None 9.
Bsmt Gar # Cars 0		Entrance Code 5 Estimated
Wet Basement 0		1.Interior 4.Vacant 7.Entered
1.Dry 4. 7.		2.Refusal 5.Estimate 8.No
2.Damp 5. 8.		3.Informed 6.Reviewed 9.Land
3.Wet 6. 9.		Information Code 5 Estimate
		1.Owner 4.Agent 7.
		2.Relative 5.Estimate 8.
		3.Tenant 6.Other 9.

Date Inspected

Additions, Outbuildings & Improvements

Type	Year	Units	Grade	Cond	Phys.	Funct.	Sound Value
69 Workshop	1997	272	3 100	4	0 %	100 %	
69 Workshop	2015	120	3 100	4	0 %	100 %	
113 FIELD OFFICE	2019	676	3 100	4	0 %	100 %	
96 Slab for House	2019	676	3 100	4	0 %	100 %	
21 Open Frame	2019	156	3 100	4	0 %	100 %	
85 Bathroom 3Pc	2019	1	3 100	4	0 %	100 %	
86 Bathroom 2Pc	2019	1	3 100	4	0 %	100 %	
					%	%	
					%	%	
					%	%	

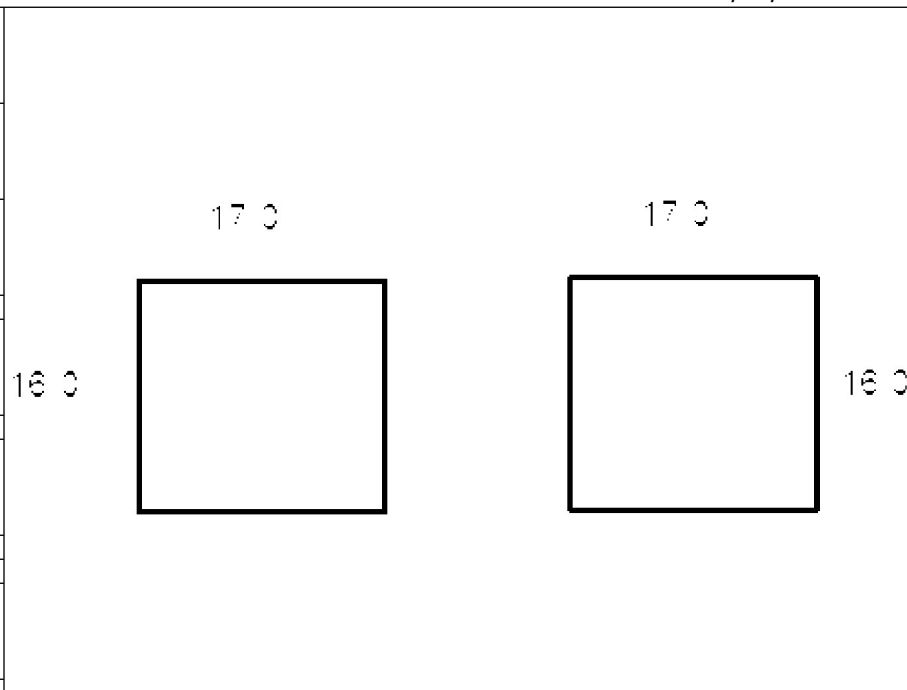

BOWDOIN AGGREGATE SALES, INC
P. O. BOX 308
BRUNSWICK ME 04011

B1876P18 B2818P31 B2818P33 B2020RP7934

Previous Owner
LABBE & SONS INC, RAY
DBA - Bowdoin Aggregate Sales (BAS)
P.O. Box 308
BRUNSWICK ME 04011
Sale Date: 10/13/2020

Previous Owner
JONES FARM, LLC
4 HIGHLAND RD

BRUNSWICK ME 04011
Sale Date: 1/20/2007

Previous Owner
PPR LABBE
4 HIGHLAND RD

BRUNSWICK ME 04011
Sale Date: 1/02/2007

Inspection Witnessed By:

X	Date
No./Date	Description

Notes:

Bowdoin

Property Data			Assessment Record						
Neighborhood 5 Map 5			Year	Land	Buildings	Exempt	Total		
Tree Growth Year 0			2009	46,000	0	0	46,000		
Farmland Yr 0			2010	46,000	0	0	46,000		
Open Space Yr 0			2011	66,000	0	0	66,000		
Zone/Land Use 11 Residential 1			2012	66,000	0	0	66,000		
Secondary Zone			2013	66,000	0	0	66,000		
Topography			2014	66,000	0	0	66,000		
1.Level 4.Below St 7.LevelBog			2015	53,330	0	0	53,330		
2.Rolling 5.Low 8.Conform			2016	53,330	0	0	53,330		
3.Above St 6.FZone 9.Non-Confor			2017	53,330	0	0	53,330		
Utilities			2018	53,330	0	0	53,330		
1.Public 4.Dr Well 7.Cesspool			2019	53,330	0	0	53,330		
2.Water 5.Dug Well 8.			2020	53,330	0	0	53,330		
3.Sewer 6.Septic 9.None			2021	53,330	0	0	53,330		
Street 5 Right-Of-Way			2022	53,330	0	0	53,330		
1.Paved 4.Proposed 7.MHG			Land Data						
2.Semi Imp 5.R/O/W 8.DIS									
3.Gravel 6.MHP 9.None			Front Foot	Type	Effective		Influence		Influence Codes
TG PLAN YEAR 0			11.Road Frontage		Frontage	Depth	Factor	Code	
Tif District # 0			12.Delta Triangle				%		1.Unimproved
Sale Data			13.Nabla Triangle				%		2.Excess Frtg
Sale Date 10/13/2020			14.Rear Land				%		3.Topography
Price			15.Miscellaneous				%		4.Size/Shape
Sale Type 7 Comm/Ind L&B							%		5.Access
1.Land 4.Mobile 7.C/I L&B							%		6.Restriction
2.L & B 5.Other 8.			Square Foot	Square Feet					7.Open Space
3.Building 6.C/I Land 9.			16.Regular Lot				%		8.View/Environ
Financing 9 Unknown			17.Secondary Lot				%		9.Fract Share
1.Convent 4.Seller 7.			18.Hydro Facility				%		Acres
2.FHA/VA 5.Private 8.			19.Improvements				%		30.Rear Land 3
3.Assumed 6.Cash 9.Unknown			20.Base 3 (Fract)				%		31.Tillable
Validity 8 Other Non Valid							%		32.Pasture
1.Valid 4.Split 7.Renovate			Fract. Acre	Acres/Sites					33.Orchard
2.Related 5.Partial 8.Other			21.Base 1 (Fract)	30	32.00	100	%	0	34.Softwood F&O
3.Distress 6.Exempt 9.Short			22.Base 2 (Fract)	27	23.00	100	%	0	35.Mixed Wood F&O
Verified 5 Public Record			23.Base 3	41	1.00	100	%	0	36.Hardwood F&O
1.Buyer 4.Agent 7.Family			Acres				%		37.Softwood TG
2.Seller 5.Pub Rec 8.Other			24.Base 1				%		38.Mixed Wood TG
3.Lender 6.MLS 9.			25.Base 2				%		39.Hardwood TG
			26.Frontage 1				%		40.Wasteland
			27.Rear Land 4				%		41.Commercial
			28.Rear Land 1				%		42.2nd Site
			29.Rear Land 2				%		43.Post Rd
			Total Acreage		55.00				44.Lot Improvemen
									45.Subdivision Lo
									46.Golf Course

Bowdoin

Map Lot 05-35-01

Account 510

Location LEWIS HILL RD

Card 1 Of 1 7/19/2022

Building Style 0 Not Coded	SF Bsmt Living 0	Layout 0
0.Not Code 4.Cape 8.Log	Fin Bsmt Grade 0 0	1.Typical 4. 7.
1.Conv. 5.Garrison 9.Other	OCCUPANCY 0	2.Inadeq 5. 8.
2.Ranch 6.Split 10.DW	Heat Type 100% 0 Not Coded	3.Poor 6. 9.
3.R Ranch 7.Contemp 11.Church	0.Not Code 4.Steam 8.FI/Wall	Attic 0
Dwelling Units 0	1.HWBB 5.FWA 9.No Heat	1.1/4 Fin 4.Full Fin 7.
Other Units 0	2.HWCI 6.GravWA 11.	2.1/2 Fin 5.FI/Stair 8.
Stories 0	3.H Pump 7.Electric 12.	3.3/4 Fin 6. 9.None
1.1 4.1.5 7.4	Cool Type 0% 9 None	Insulation 0
2.2 5.1.75 8.20	1.Refrig 4.W&C Air 7.	1.Full 4.Minimal 7.
3.3 6.2.5 9.Yurt	2.Evapor 5. 8.	2.Heavy 5. 8.
Exterior Walls 0 Not Coded	3.H Pump 6. 9.None	3.Capped 6. 9.None
0.Not Code 4.Asbestos 8.Concrete	Kitchen Style 0	Unfinished % 0%
1.Wood 5.Stucco 9.Other	1.Modern 4.Obsolete 7.	Grade & Factor 0 0%
2.Vin/Al 6.Brick 10.Board B	2.Typical 5. 8.	1.E Grade 4.B Grade 7.
3.Compos. 7.Stone 12.	3.Old Type 6. 9.None	2.D Grade 5.A Grade 8.
Roof Surface 0	Bath(s) Style 0	3.C Grade 6.AA Grade 9.Same
1.Asphalt 4.Composit 7.	1.Modern 4.Obsolete 7.	SQFT (Footprint) 0
2.Slate 5.Wood 8.	2.Typical 5. 8.	Condition 0
3.Metal 6.Other 9.	3.Old Type 6. 9.None	1.Poor 4.Avg 7.V G
SF Masonry Trim 0	# Rooms 0	2.Fair 5.Avg+ 8.Exc
SEPTIC DESIGN 0	# Bedrooms 0	3.Avg- 6.Good 9.Same
BLDG PERMIT 0	# Full Baths 0	Phys. % Good 0%
Year Built 0	# Half Baths 0	Funct. % Good 100%
Year Remodeled 0	# Addn Fixtures 0	Functional Code 9 None
Foundation 0	# Fireplaces 0	1.Incomp 4.Delap 7.No Power
1.Concrete 4.Wood 7.		2.O-Built 5.Bsmt 8.LongTerm
2.C Block 5.Slab 8.		3.Damage 6.Dbwd 9.None
3.Br/Stone 6.Piers 9.		Econ. % Good 100%
Basement 0		Economic Code None
1.1/4 Bmt 4.Full Bmt 7.		0.None 3.No Power 7.
2.1/2 Bmt 5.None 8.		1.Location 4.Generate 8.
3.3/4 Bmt 6. 9.None		2.Encroach 9.None 9.
Bsmt Gar # Cars 0		Entrance Code 0
Wet Basement 0		1.Interior 4.Vacant 7.Entered
1.Dry 4. 7.		2.Refusal 5.Estimate 8.No
2.Damp 5. 8.		3.Informed 6.Reviewed 9.Land
3.Wet 6. 9.		Information Code 0
		1.Owner 4.Agent 7.
		2.Relative 5.Estimate 8.
		3.Tenant 6.Other 9.



Date Inspected

Additions, Outbuildings & Improvements							
Type	Year	Units	Grade	Cond	Phys.	Funct.	Sound Value
					%	%	1.One Story Fram
					%	%	2.Two Story Fram
					%	%	3.Three Story Fr
					%	%	4.1 & 1/2 Story
					%	%	5.1 & 3/4 Story
					%	%	6.2 & 1/2 Story
					%	%	21.Open Frame Por
					%	%	22.Encl Frame Por
					%	%	23.Attached Garag
					%	%	24.Frame Shed
					%	%	25.Frame Bay Wind
					%	%	26.1SFr Overhang
					%	%	27.Unfin Basement
					%	%	28.Unfinished Att
					%	%	29.Finished Attic

STROBEL, MONICA
129 LITCHFIELD RD
BOWDOIN ME 04287

B1640P121

Inspection Witnessed By:

No./Date	Description	Date Insp.
X		

Notes:

Bowdoin

Property Data			Assessment Record				
Neighborhood 5 Map 5			Year	Land	Buildings	Exempt	Total
Tree Growth Year 0			2009	28,500	0	0	28,500
Farmland Yr 0			2010	28,500	0	0	28,500
Open Space Yr 0			2011	28,500	0	0	28,500
Zone/Land Use 11 Residential 1			2012	31,000	0	0	31,000
Secondary Zone			2013	31,000	0	0	31,000
Topography			2014	31,000	0	0	31,000
1.Level 4.Below St 7.LevelBog			2015	31,000	0	0	31,000
2.Rolling 5.Low 8.Conform			2016	31,000	0	0	31,000
3.Above St 6.FZone 9.Non-Confor			2017	31,000	0	0	31,000
Utilities			2018	31,000	0	0	31,000
1.Public 4.Dr Well 7.Cesspool			2019	31,000	0	0	31,000
2.Water 5.Dug Well 8.			2020	31,000	0	0	31,000
3.Sewer 6.Septic 9.None			2021	31,000	0	0	31,000
Street			2022	31,000	0	0	31,000
1.Paved 4.Proposed 7.MHG			Land Data				
2.Semi Imp 5.R/O/W 8.DIS							
3.Gravel 6.MHP 9.None			Front Foot				
TG PLAN YEAR 0							
Tif District # 0			Type				
Sale Data							
Sale Date			Effective				
Price							
Sale Type			Influence				
1.Land 4.Mobile 7.C/I L&B							
2.L & B 5.Other 8.			Influence Codes				
3.Building 6.C/I Land 9.							
Financing			Square Foot				
1.Convent 4.Seller 7.							
2.FHA/VA 5.Private 8.			Square Feet				
3.Assumed 6.Cash 9.Unknown							
Validity			Fract. Acre				
1.Valid 4.Split 7.Renovate							
2.Related 5.Partial 8.Other			Acres				
3.Distress 6.Exempt 9.Short							
Verified			Acres				
1.Buyer 4.Agent 7.Family							
2.Seller 5.Pub Rec 8.Other			Total Acreage 16.00				
3.Lender 6.MLS 9.							

- 1.Unimproved
- 2.Excess Frtg
- 3.Topography
- 4.Size/Shape
- 5.Access
- 6.Restriction
- 7.Open Space
- 8.View/Environ
- 9.Fract Share
- Acres**
- 30.Rear Land 3
- 31.Tillable
- 32.Pasture
- 33.Orchard
- 34.Softwood F&O
- 35.Mixed Wood F&O
- 36.Hardwood F&O
- 37.Softwood TG
- 38.Mixed Wood TG
- 39.Hardwood TG
- 40.Wasteland
- 41.Commercial
- 42.2nd Site
- 43.Post Rd
- 44.Lot Improvemen
- 45.Subdivision Lo
- 46.Golf Course

Bowdoin

Map Lot 05-35-02

Account 511

Location LITCHFIELD RD

Card 1 Of 1 7/19/2022

Building Style 0 Not Coded	SF Bsmt Living 0	Layout 0
0.Not Code 4.Cape 8.Log	Fin Bsmt Grade 0 0	1.Typical 4. 7.
1.Conv. 5.Garrison 9.Other	OCCUPANCY 0	2.Inadeq 5. 8.
2.Ranch 6.Split 10.DW	Heat Type 100% 0 Not Coded	3.Poor 6. 9.
3.R Ranch 7.Contemp 11.Church	0.Not Code 4.Steam 8.FI/Wall	Attic 0
Dwelling Units 0	1.HWBB 5.FWA 9.No Heat	1.1/4 Fin 4.Full Fin 7.
Other Units 0	2.HWCI 6.GravWA 11.	2.1/2 Fin 5.FI/Stair 8.
Stories 0	3.H Pump 7.Electric 12.	3.3/4 Fin 6. 9.None
1.1 4.1.5 7.4	Cool Type 0% 9 None	Insulation 0
2.2 5.1.75 8.20	1.Refrig 4.W&C Air 7.	1.Full 4.Minimal 7.
3.3 6.2.5 9.Yurt	2.Evapor 5. 8.	2.Heavy 5. 8.
Exterior Walls 0 Not Coded	3.H Pump 6. 9.None	3.Capped 6. 9.None
0.Not Code 4.Asbestos 8.Concrete	Kitchen Style 0	Unfinished % 0%
1.Wood 5.Stucco 9.Other	1.Modern 4.Obsolete 7.	Grade & Factor 0 0%
2.Vin/Al 6.Brick 10.Board B	2.Typical 5. 8.	1.E Grade 4.B Grade 7.
3.Compos. 7.Stone 12.	3.Old Type 6. 9.None	2.D Grade 5.A Grade 8.
Roof Surface 0	Bath(s) Style 0	3.C Grade 6.AA Grade 9.Same
1.Asphalt 4.Composit 7.	1.Modern 4.Obsolete 7.	SQFT (Footprint) 0
2.Slate 5.Wood 8.	2.Typical 5. 8.	Condition 0
3.Metal 6.Other 9.	3.Old Type 6. 9.None	1.Poor 4.Avg 7.V G
SF Masonry Trim 0	# Rooms 0	2.Fair 5.Avg+ 8.Exc
SEPTIC DESIGN 0	# Bedrooms 0	3.Avg- 6.Good 9.Same
BLDG PERMIT 0	# Full Baths 0	Phys. % Good 0%
Year Built 0	# Half Baths 0	Funct. % Good 100%
Year Remodeled 0	# Addn Fixtures 0	Functional Code 9 None
Foundation 0	# Fireplaces 0	1.Incomp 4.Delap 7.No Power
1.Concrete 4.Wood 7.		2.O-Built 5.Bsmt 8.LongTerm
2.C Block 5.Slab 8.		3.Damage 6.Dbwd 9.None
3.Br/Stone 6.Piers 9.		Econ. % Good 100%
Basement 0		Economic Code None
1.1/4 Bmt 4.Full Bmt 7.		0.None 3.No Power 7.
2.1/2 Bmt 5.None 8.		1.Location 4.Generate 8.
3.3/4 Bmt 6. 9.None		2.Encroach 9.None 9.
Bsmt Gar # Cars 0		Entrance Code 0
Wet Basement 0		1.Interior 4.Vacant 7.Entered
1.Dry 4. 7.		2.Refusal 5.Estimate 8.No
2.Damp 5. 8.	3.Informed 6.Reviewed 9.Land	
3.Wet 6. 9.	Information Code 0	
	1.Owner 4.Agent 7.	
	2.Relative 5.Estimate 8.	
	3.Tenant 6.Other 9.	

Date Inspected

Additions, Outbuildings & Improvements								
Type	Year	Units	Grade	Cond	Phys.	Funct.	Sound Value	
					%	%		1.One Story Fram
					%	%		2.Two Story Fram
					%	%		3.Three Story Fr
					%	%		4.1 & 1/2 Story
					%	%		5.1 & 3/4 Story
					%	%		6.2 & 1/2 Story
					%	%		21.Open Frame Por
					%	%		22.Encl Frame Por
					%	%		23.Attached Garag
					%	%		24.Frame Shed
					%	%		25.Frame Bay Wind
					%	%		26.1SFr Overhang
					%	%		27.Unfin Basement
					%	%		28.Unfinished Att
					%	%		29.Finished Attic

LEVESQUE, JAMES D
LEVESQUE, ELLEN S
62 LITCHFIELD RD
BOWDOIN ME 04287

B795P191

Inspection Witnessed By:

X		Date
No./Date	Description	Date Insp.

Notes:

Bowdoin

Property Data			Assessment Record																																																																																																																																																																																																												
Neighborhood 5 Map 5			Year	Land	Buildings	Exempt	Total																																																																																																																																																																																																								
Tree Growth Year 0			2009	49,600	98,540	13,000	135,140																																																																																																																																																																																																								
Farmland Yr 0			2010	49,600	98,540	10,000	138,140																																																																																																																																																																																																								
Open Space Yr 0			2011	49,600	98,540	10,000	138,140																																																																																																																																																																																																								
Zone/Land Use 11 Residential 1			2012	49,600	98,540	10,000	138,140																																																																																																																																																																																																								
Secondary Zone			2013	49,600	98,540	10,000	138,140																																																																																																																																																																																																								
Topography			2014	49,600	98,540	10,000	138,140																																																																																																																																																																																																								
1.Level 4.Below St 7.LevelBog			2015	49,600	98,540	10,000	138,140																																																																																																																																																																																																								
2.Rolling 5.Low 8.Conform			2016	49,600	98,540	15,000	133,140																																																																																																																																																																																																								
3.Above St 6.FZone 9.Non-Confor			2017	49,600	98,540	20,000	128,140																																																																																																																																																																																																								
Utilities			2018	49,600	98,540	20,000	128,140																																																																																																																																																																																																								
1.Public 4.Dr Well 7.Cesspool			2019	49,600	98,540	20,000	128,140																																																																																																																																																																																																								
2.Water 5.Dug Well 8.			2020	49,600	98,540	25,000	123,140																																																																																																																																																																																																								
3.Sewer 6.Septic 9.None			2021	49,600	98,540	25,000	123,140																																																																																																																																																																																																								
Street 1 Paved			2022	49,600	90,190	21,500	118,290																																																																																																																																																																																																								
1.Paved 4.Proposed 7.MHG			Land Data																																																																																																																																																																																																												
2.Semi Imp 5.R/O/W 8.DIS																																																																																																																																																																																																															
3.Gravel 6.MHP 9.None			<table border="1"> <thead> <tr> <th rowspan="2">Front Foot</th> <th rowspan="2">Type</th> <th colspan="2">Effective</th> <th colspan="2">Influence</th> <th rowspan="2">Influence Codes</th> </tr> <tr> <th>Frontage</th> <th>Depth</th> <th>Factor</th> <th>Code</th> </tr> </thead> <tbody> <tr> <td>11.Road Frontage</td> <td></td> <td></td> <td></td> <td>%</td> <td></td> <td>1.Unimproved</td> </tr> <tr> <td>12.Delta Triangle</td> <td></td> <td></td> <td></td> <td>%</td> <td></td> <td>2.Excess Frtg</td> </tr> <tr> <td>13.Nabla Triangle</td> <td></td> <td></td> <td></td> <td>%</td> <td></td> <td>3.Topography</td> </tr> <tr> <td>14.Rear Land</td> <td></td> <td></td> <td></td> <td>%</td> <td></td> <td>4.Size/Shape</td> </tr> <tr> <td>15.Miscellaneous</td> <td></td> <td></td> <td></td> <td>%</td> <td></td> <td>5.Access</td> </tr> <tr> <td></td> <td></td> <td></td> <td></td> <td>%</td> <td></td> <td>6.Restriction</td> </tr> <tr> <td></td> <td></td> <td></td> <td></td> <td>%</td> <td></td> <td>7.Open Space</td> </tr> <tr> <td></td> <td></td> <td></td> <td></td> <td>%</td> <td></td> <td>8.View/Environ</td> </tr> <tr> <td></td> <td></td> <td></td> <td></td> <td>%</td> <td></td> <td>9.Fract Share</td> </tr> <tr> <td></td> <td></td> <td></td> <td></td> <td>%</td> <td></td> <td>Acres</td> </tr> <tr> <td></td> <td></td> <td></td> <td></td> <td>%</td> <td></td> <td>30.Rear Land 3</td> </tr> <tr> <td></td> <td></td> <td></td> <td></td> <td>%</td> <td></td> <td>31.Tillable</td> </tr> <tr> <td></td> <td></td> <td></td> <td></td> <td>%</td> <td></td> <td>32.Pasture</td> </tr> <tr> <td></td> <td></td> <td></td> <td></td> <td>%</td> <td></td> <td>33.Orchard</td> </tr> <tr> <td></td> <td></td> <td></td> <td></td> <td>%</td> <td></td> <td>34.Softwood F&O</td> </tr> <tr> <td></td> <td></td> <td></td> <td></td> <td>%</td> <td></td> <td>35.Mixed Wood F&O</td> </tr> <tr> <td></td> <td></td> <td></td> <td></td> <td>%</td> <td></td> <td>36.Hardwood F&O</td> </tr> <tr> <td></td> <td></td> <td></td> <td></td> <td>%</td> <td></td> <td>37.Softwood TG</td> </tr> <tr> <td></td> <td></td> <td></td> <td></td> <td>%</td> <td></td> <td>38.Mixed Wood TG</td> </tr> <tr> <td></td> <td></td> <td></td> <td></td> <td>%</td> <td></td> <td>39.Hardwood TG</td> </tr> <tr> <td></td> <td></td> <td></td> <td></td> <td>%</td> <td></td> <td>40.Wasteland</td> </tr> <tr> <td></td> <td></td> <td></td> <td></td> <td>%</td> <td></td> <td>41.Commercial</td> </tr> <tr> <td></td> <td></td> <td></td> <td></td> <td>%</td> <td></td> <td>42.2nd Site</td> </tr> <tr> <td></td> <td></td> <td></td> <td></td> <td>%</td> <td></td> <td>43.Post Rd</td> </tr> <tr> <td></td> <td></td> <td></td> <td></td> <td>%</td> <td></td> <td>44.Lot Improvemen</td> </tr> <tr> <td></td> <td></td> <td></td> <td></td> <td>%</td> <td></td> <td>45.Subdivision Lo</td> </tr> <tr> <td></td> <td></td> <td></td> <td></td> <td>%</td> <td></td> <td>46.Golf Course</td> </tr> </tbody> </table>					Front Foot	Type	Effective		Influence		Influence Codes	Frontage	Depth	Factor	Code	11.Road Frontage				%		1.Unimproved	12.Delta Triangle				%		2.Excess Frtg	13.Nabla Triangle				%		3.Topography	14.Rear Land				%		4.Size/Shape	15.Miscellaneous				%		5.Access					%		6.Restriction					%		7.Open Space					%		8.View/Environ					%		9.Fract Share					%		Acres					%		30.Rear Land 3					%		31.Tillable					%		32.Pasture					%		33.Orchard					%		34.Softwood F&O					%		35.Mixed Wood F&O					%		36.Hardwood F&O					%		37.Softwood TG					%		38.Mixed Wood TG					%		39.Hardwood TG					%		40.Wasteland					%		41.Commercial					%		42.2nd Site					%		43.Post Rd					%		44.Lot Improvemen					%		45.Subdivision Lo					%		46.Golf Course
Front Foot	Type	Effective								Influence		Influence Codes																																																																																																																																																																																																			
		Frontage	Depth	Factor	Code																																																																																																																																																																																																										
11.Road Frontage				%		1.Unimproved																																																																																																																																																																																																									
12.Delta Triangle				%		2.Excess Frtg																																																																																																																																																																																																									
13.Nabla Triangle				%		3.Topography																																																																																																																																																																																																									
14.Rear Land				%		4.Size/Shape																																																																																																																																																																																																									
15.Miscellaneous				%		5.Access																																																																																																																																																																																																									
				%		6.Restriction																																																																																																																																																																																																									
				%		7.Open Space																																																																																																																																																																																																									
				%		8.View/Environ																																																																																																																																																																																																									
				%		9.Fract Share																																																																																																																																																																																																									
				%		Acres																																																																																																																																																																																																									
				%		30.Rear Land 3																																																																																																																																																																																																									
				%		31.Tillable																																																																																																																																																																																																									
				%		32.Pasture																																																																																																																																																																																																									
				%		33.Orchard																																																																																																																																																																																																									
				%		34.Softwood F&O																																																																																																																																																																																																									
				%		35.Mixed Wood F&O																																																																																																																																																																																																									
				%		36.Hardwood F&O																																																																																																																																																																																																									
				%		37.Softwood TG																																																																																																																																																																																																									
				%		38.Mixed Wood TG																																																																																																																																																																																																									
				%		39.Hardwood TG																																																																																																																																																																																																									
				%		40.Wasteland																																																																																																																																																																																																									
				%		41.Commercial																																																																																																																																																																																																									
				%		42.2nd Site																																																																																																																																																																																																									
				%		43.Post Rd																																																																																																																																																																																																									
				%		44.Lot Improvemen																																																																																																																																																																																																									
				%		45.Subdivision Lo																																																																																																																																																																																																									
				%		46.Golf Course																																																																																																																																																																																																									
TG PLAN YEAR 0			Square Foot																																																																																																																																																																																																												
Tif District # 0			16.Regular Lot																																																																																																																																																																																																												
Sale Data			17.Secondary Lot																																																																																																																																																																																																												
			18.Hydro Facility																																																																																																																																																																																																												
Sale Date			19.Improvements																																																																																																																																																																																																												
Price			20.Base 3 (Fract)																																																																																																																																																																																																												
Sale Type			Fract. Acre																																																																																																																																																																																																												
1.Land 4.Mobile 7.C/I L&B			21.Base 1 (Fract)																																																																																																																																																																																																												
2.L & B 5.Other 8.			22.Base 2 (Fract)																																																																																																																																																																																																												
3.Building 6.C/I Land 9.			23.Base 3																																																																																																																																																																																																												
Financing			Acres																																																																																																																																																																																																												
1.Convent 4.Seller 7.			24.Base 1																																																																																																																																																																																																												
2.FHA/VA 5.Private 8.			25.Base 2																																																																																																																																																																																																												
3.Assumed 6.Cash 9.Unknown			26.Frontage 1																																																																																																																																																																																																												
Validity			27.Rear Land 4																																																																																																																																																																																																												
1.Valid 4.Split 7.Renovate			28.Rear Land 1																																																																																																																																																																																																												
2.Related 5.Partial 8.Other			29.Rear Land 2																																																																																																																																																																																																												
3.Distress 6.Exempt 9.Short			Total Acreage 2.50																																																																																																																																																																																																												
Verified																																																																																																																																																																																																															
1.Buyer 4.Agent 7.Family																																																																																																																																																																																																															
2.Seller 5.Pub Rec 8.Other																																																																																																																																																																																																															
3.Lender 6.MLS 9.																																																																																																																																																																																																															

Bowdoin

Map Lot 05-36-0

Account 512

Location 62 LITCHFIELD RD

Card 1 Of 1 7/19/2022

Building Style 2 Ranch	SF Bsmt Living 0	Layout 1 Typical
0.Not Code 4.Cape 8.Log	Fin Bsmt Grade 0 0	1.Typical 4. 7.
1.Conv. 5.Garrison 9.Other	OCCUPANCY 0	2.Inadeq 5. 8.
2.Ranch 6.Split 10.DW	Heat Type 100% 1 Hot Water BB	3.Poor 6. 9.
3.R Ranch 7.Contemp 11.Church	0.Not Code 4.Steam 8.FI/Wall	Attic 9 None
Dwelling Units 1	1.HWBB 5.FWA 9.No Heat	1.1/4 Fin 4.Full Fin 7.
Other Units 0	2.HWCI 6.GravWA 11.	2.1/2 Fin 5.FI/Stair 8.
Stories 1 One Story	3.H Pump 7.Electric 12.	3.3/4 Fin 6. 9.None
1.1 4.1.5 7.4	Cool Type 0% 9 None	Insulation 1 Full
2.2 5.1.75 8.20	1.Refrig 4.W&C Air 7.	1.Full 4.Minimal 7.
3.3 6.2.5 9.Yurt	2.Evapor 5. 8.	2.Heavy 5. 8.
Exterior Walls 2 Vinyl/Aluminum	3.H Pump 6. 9.None	3.Capped 6. 9.None
0.Not Code 4.Asbestos 8.Concrete	Kitchen Style 2 Typical	Unfinished % 0%
1.Wood 5.Stucco 9.Other	1.Modern 4.Obsolete 7.	Grade & Factor 3 Average 100%
2.Vin/Al 6.Brick 10.Board B	2.Typical 5. 8.	1.E Grade 4.B Grade 7.
3.Compos. 7.Stone 12.	3.Old Type 6. 9.None	2.D Grade 5.A Grade 8.
Roof Surface 1 Asphalt Shingles	Bath(s) Style 2 Typical Bath(s)	3.C Grade 6.AA Grade 9.Same
1.Asphalt 4.Composit 7.	1.Modern 4.Obsolete 7.	SQFT (Footprint) 1092
2.Slate 5.Wood 8.	2.Typical 5. 8.	Condition 3 Below Average
3.Metal 6.Other 9.	3.Old Type 6. 9.None	1.Poor 4.Avg 7.V G
SF Masonry Trim 0	# Rooms 7	2.Fair 5.Avg+ 8.Exc
SEPTIC DESIGN 0	# Bedrooms 3	3.Avg- 6.Good 9.Same
BLDG PERMIT 0	# Full Baths 1	Phys. % Good 0%
Year Built 1965	# Half Baths 1	Funct. % Good 100%
Year Remodeled 0	# Addn Fixtures 0	Functional Code 9 None
Foundation 1 Concrete	# Fireplaces 0	1.Incomp 4.Delap 7.No Power
1.Concrete 4.Wood 7.		2.O-Built 5.Bsmt 8.LongTerm
2.C Block 5.Slab 8.		3.Damage 6.Dbwd 9.None
3.Br/Stone 6.Piers 9.		Econ. % Good 100%
Basement 4 Full Basement		Economic Code None
1.1/4 Bmt 4.Full Bmt 7.		0.None 3.No Power 7.
2.1/2 Bmt 5.None 8.		1.Location 4.Generate 8.
3.3/4 Bmt 6. 9.None		2.Encroach 9.None 9.
Bsmt Gar # Cars 0		Entrance Code 3 Information Only
Wet Basement 3 Wet Basement		1.Interior 4.Vacant 7.Entered
1.Dry 4. 7.		2.Refusal 5.Estimate 8.No
2.Damp 5. 8.	3.Informed 6.Reviewed 9.Land	
3.Wet 6. 9.	Information Code 1 Owner	
	1.Owner 4.Agent 7.	
	2.Relative 5.Estimate 8.	
	3.Tenant 6.Other 9.	

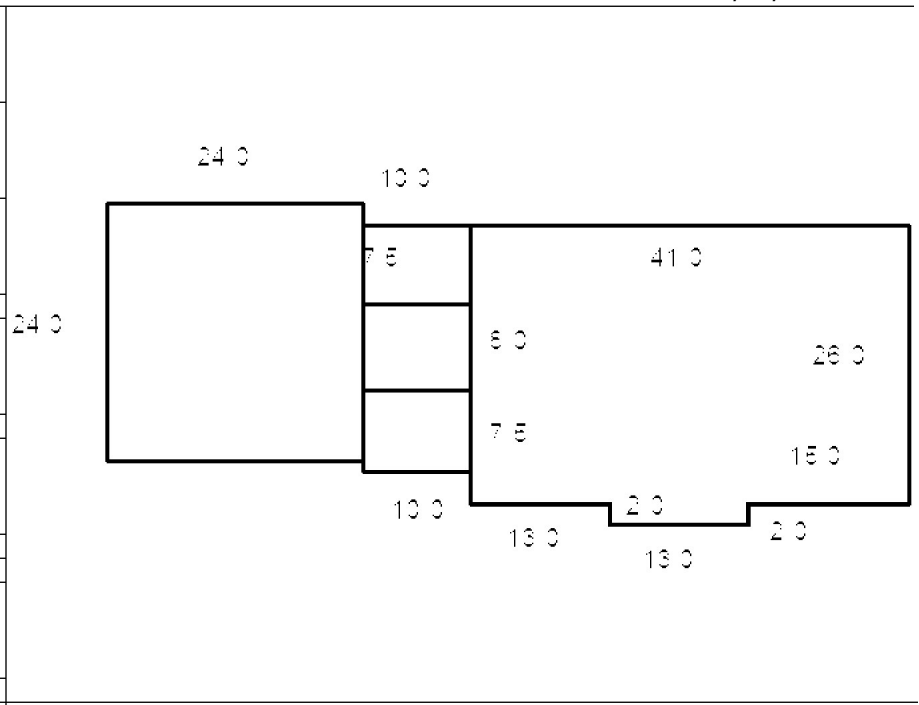

Date Inspected

Additions, Outbuildings & Improvements

Type	Year	Units	Grade	Cond	Phys.	Funct.	Sound Value
1 One Story Frame	1975	576	3 100	4	0 %	100 %	
68 Wood Deck	2004	75	3 100	4	0 %	100 %	
22 Encl Frame Porch	2004	80	3 100	4	0 %	100 %	
68 Wood Deck	2004	75	3 100	4	0 %	100 %	
					%	%	
					%	%	
					%	%	
					%	%	
					%	%	
					%	%	
					%	%	



OCT 17 2006

KROUSE, JULIETTE
MOORE, WILLIAM CODY
64 LITCHFIELD RD
BOWDOIN ME 04287

B1824P25 B2009P216 B2602P276 B2019RP8402

Previous Owner
BRADY, LARRY E
64 LITCHFIELD RD

BOWDOIN ME 04287
Sale Date: 12/06/2019

Property Data			Assessment Record				
Neighborhood 5 Map 5			Year	Land	Buildings	Exempt	Total
Tree Growth Year 0			2009	88,500	134,440	0	222,940
Farmland Yr 0			2010	88,500	134,440	0	222,940
Open Space Yr 0			2011	88,500	134,440	0	222,940
Zone/Land Use 11 Residential 1			2012	84,500	134,440	0	218,940
Secondary Zone			2013	84,500	136,460	0	220,960
Topography			2014	84,500	136,460	0	220,960
1.Level 4.Below St 7.LevelBog			2015	84,500	136,460	0	220,960
2.Rolling 5.Low 8.Conform			2016	84,500	136,460	0	220,960
3.Above St 6.FZone 9.Non-Confor			2017	84,500	136,460	0	220,960
Utilities			2018	84,500	136,460	0	220,960
1.Public 4.Dr Well 7.Cesspool			2019	84,500	136,460	0	220,960
2.Water 5.Dug Well 8.			2020	84,500	136,460	0	220,960
3.Sewer 6.Septic 9.None			2021	84,500	136,460	0	220,960
Street 1 Paved			2022	84,500	130,590	0	215,090
1.Paved 4.Proposed 7.MHG							
2.Semi Imp 5.R/O/W 8.DIS							
3.Gravel 6.MHP 9.None							
TG PLAN YEAR 0							
Tif District # 0							

Inspection Witnessed By:

X Date

No./Date	Description	Date Insp.

Notes:

Sale Data		
Sale Date 12/06/2019		
Price 240,000		
Sale Type 2 Land & Buildings		
1.Land 4.Mobile 7.C/I L&B		
2.L & B 5.Other 8.		
3.Building 6.C/I Land 9.		
Financing 9 Unknown		
1.Convent 4.Seller 7.		
2.FHA/VA 5.Private 8.		
3.Assumed 6.Cash 9.Unknown		
Validity 1 Arms Length Sale		
1.Valid 4.Split 7.Renovate		
2.Related 5.Partial 8.Other		
3.Distress 6.Exempt 9.Short		
Verified 5 Public Record		
1.Buyer 4.Agent 7.Family		
2.Seller 5.Pub Rec 8.Other		
3.Lender 6.MLS 9.		

Land Data						
Front Foot	Type	Effective		Influence		Influence Codes
		Frontage	Depth	Factor	Code	
11.Road Frontage				%		1.Unimproved
12.Delta Triangle				%		2.Excess Frtg
13.Nabla Triangle				%		3.Topography
14.Rear Land				%		4.Size/Shape
15.Miscellaneous				%		5.Access
				%		6.Restriction
				%		7.Open Space
				%		8.View/Environ
				%		9.Fract Share
				%		Acres
				%		30.Rear Land 3
				%		31.Tillable
				%		32.Pasture
				%		33.Orchard
				%		34.Softwood F&O
				%		35.Mixed Wood F&O
				%		36.Hardwood F&O
				%		37.Softwood TG
				%		38.Mixed Wood TG
				%		39.Hardwood TG
				%		40.Wasteland
				%		41.Commercial
				%		42.2nd Site
				%		43.Post Rd
				%		44.Lot Improvemen
				%		45.Subdivision Lo
				%		46.Golf Course
Total Acreage		32.00				

Bowdoin

Bowdoin

Map Lot 05-37-0

Account 513

Location 64 LITCHFIELD RD

Card 1

Of 1

7/19/2022

Building Style 4 Cape Cod 0.Not Code 4.Cape 8.Log 1.Conv. 5.Garrison 9.Other 2.Ranch 6.Split 10.DW 3.R Ranch 7.Contemp 11.Church	SF Bsmt Living 0 Fin Bsmt Grade 0 0 OCCUPANCY 0 Heat Type 100% 1 Hot Water BB 0.Not Code 4.Steam 8.FI/Wall 1.HWBB 5.FWA 9.No Heat 2.HWCI 6.GravWA 11. 3.H Pump 7.Electric 12.	Layout 1 Typical 1.Typical 4. 7. 2.Inadeq 5. 8. 3.Poor 6. 9. Attic 9 None 1.1/4 Fin 4.Full Fin 7. 2.1/2 Fin 5.FI/Stair 8. 3.3/4 Fin 6. 9.None	
Dwelling Units 1 Other Units 0 Stories 1 One Story 1.1 4.1.5 7.4 2.2 5.1.75 8.20 3.3 6.2.5 9.Yurt	Cool Type 0% 9 None 1.Refrig 4.W&C Air 7. 2.Evapor 5. 8. 3.H Pump 6. 9.None	Insulation 1 Full 1.Full 4.Minimal 7. 2.Heavy 5. 8. 3.Capped 6. 9.None	
Exterior Walls 2 Vinyl/Aluminum 0.Not Code 4.Asbestos 8.Concrete 1.Wood 5.Stucco 9.Other 2.Vin/Al 6.Brick 10.Board B 3.Compos. 7.Stone 12.	Kitchen Style 2 Typical 1.Modern 4.Obsolete 7. 2.Typical 5. 8. 3.Old Type 6. 9.None	Unfinished % 0% Grade & Factor 3 Average 110% 1.E Grade 4.B Grade 7. 2.D Grade 5.A Grade 8. 3.C Grade 6.AA Grade 9.Same	
Roof Surface 1 Asphalt Shingles 1.Asphalt 4.Composit 7. 2.Slate 5.Wood 8. 3.Metal 6.Other 9.	Bath(s) Style 2 Typical Bath(s) 1.Modern 4.Obsolete 7. 2.Typical 5. 8. 3.Old Type 6. 9.None	SQFT (Footprint) 1120 Condition 4 Average 1.Poor 4.Avg 7.V G 2.Fair 5.Avg+ 8.Exc 3.Avg- 6.Good 9.Same	
SF Masonry Trim 0 SEPTIC DESIGN 0 BLDG PERMIT 0 Year Built 2005 Year Remodeled 0 Foundation 1 Concrete 1.Concrete 4.Wood 7. 2.C Block 5.Slab 8. 3.Br/Stone 6.Piers 9.	# Rooms 7 # Bedrooms 3 # Full Baths 2 # Half Baths 0 # Addn Fixtures 0 # Fireplaces 0	Phys. % Good 0% Funct. % Good 100% Functional Code 9 None 1.Incomp 4.Delap 7.No Power 2.O-Built 5.Bsmt 8.LongTerm 3.Damage 6.Dbwd 9.None Econ. % Good 100% Economic Code None 0.None 3.No Power 7. 1.Location 4.Generate 8. 2.Encroach 9.None 9.	
Basement 4 Full Basement 1.1/4 Bmt 4.Full Bmt 7. 2.1/2 Bmt 5.None 8. 3.3/4 Bmt 6. 9.None Bsmt Gar # Cars 0 Wet Basement 1 Dry Basement 1.Dry 4. 7. 2.Damp 5. 8. 3.Wet 6. 9.			Entrance Code 5 Estimated 1.Interior 4.Vacant 7.Entered 2.Refusal 5.Estimate 8.No 3.Informed 6.Reviewed 9.Land Information Code 5 Estimate 1.Owner 4.Agent 7. 2.Relative 5.Estimate 8. 3.Tenant 6.Other 9.

Date Inspected 4/18/2006

Additions, Outbuildings & Improvements

Type	Year	Units	Grade	Cond	Phys.	Funct.	Sound Value	
68 Wood Deck	2005	64	3 105	0	0 %	0 %		1.One Story Fram
68 Wood Deck	2005	256	3 105	0	0 %	0 %		2.Two Story Fram
67 Stable	0	384	0 0	0	0 %	0 %		3.Three Story Fr
					%	%		4.1 & 1/2 Story
					%	%		5.1 & 3/4 Story
					%	%		6.2 & 1/2 Story
					%	%		21.Open Frame Por
					%	%		22.Encl Frame Por
					%	%		23.Attached Garag
					%	%		24.Frame Shed
					%	%		25.Frame Bay Wind
					%	%		26.1SFr Overhang
					%	%		27.Unfin Basement
					%	%		28.Unfinished Att
					%	%		29.Finished Attic

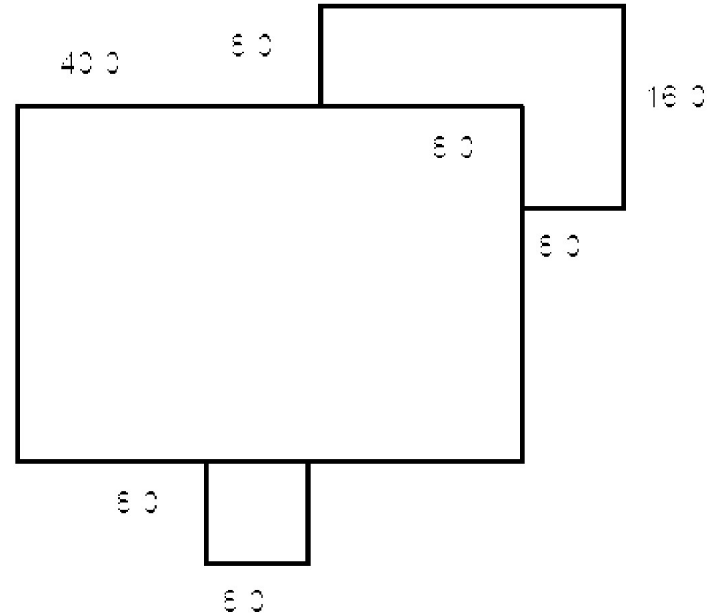

SAWYER, DEVISEES OF WILLIAM E
SAWYER, BEVERLY
65 LITCHFIELD RD
BOWDOIN ME 04287

B405P311

Inspection Witnessed By:

No./Date	Description	Date Insp.
X		

Notes:

Bowdoin

Property Data			Assessment Record				
Neighborhood 5 Map 5			Year	Land	Buildings	Exempt	Total
Tree Growth Year 0			2009	47,920	91,480	13,000	126,400
Farmland Yr 0			2010	47,920	93,620	10,000	131,540
Open Space Yr 0			2011	47,920	93,620	10,000	131,540
Zone/Land Use 11 Residential 1			2012	47,920	93,620	10,000	131,540
Secondary Zone			2013	47,920	93,620	10,000	131,540
Topography			2014	47,920	93,620	10,000	131,540
1.Level 4.Below St 7.LevelBog			2015	47,920	93,620	10,000	131,540
2.Rolling 5.Low 8.Conform			2016	47,920	93,620	15,000	126,540
3.Above St 6.FZone 9.Non-Confor			2017	47,920	93,620	20,000	121,540
Utilities			2018	47,920	93,620	20,000	121,540
1.Public 4.Dr Well 7.Cesspool			2019	47,920	93,620	20,000	121,540
2.Water 5.Dug Well 8.			2020	47,920	93,620	25,000	116,540
3.Sewer 6.Septic 9.None			2021	47,920	93,620	25,000	116,540
Street 1 Paved			2022	47,920	92,140	21,500	118,560
1.Paved 4.Proposed 7.MHG			Land Data				
2.Semi Imp 5.R/O/W 8.DIS							
3.Gravel 6.MHP 9.None			Front Foot				
TG PLAN YEAR 0							
Tif District # 0			Type				
Sale Data							
Sale Date			Effective				
Price							
Sale Type			Influence				
1.Land 4.Mobile 7.C/I L&B							
2.L & B 5.Other 8.			Influence Codes				
3.Building 6.C/I Land 9.							
Financing			Square Foot				
1.Convent 4.Seller 7.							
2.FHA/VA 5.Private 8.			Square Feet				
3.Assumed 6.Cash 9.Unknown							
Validity			Fract. Acre				
1.Valid 4.Split 7.Renovate							
2.Related 5.Partial 8.Other			Acres				
3.Distress 6.Exempt 9.Short							
Verified			Acres/Sites				
1.Buyer 4.Agent 7.Family							
2.Seller 5.Pub Rec 8.Other			Total Acreage 1.30				
3.Lender 6.MLS 9.							

- 1.Unimproved
- 2.Excess Frtg
- 3.Topography
- 4.Size/Shape
- 5.Access
- 6.Restriction
- 7.Open Space
- 8.View/Environ
- 9.Fract Share
- Acres**
- 30.Rear Land 3
- 31.Tillable
- 32.Pasture
- 33.Orchard
- 34.Softwood F&O
- 35.Mixed Wood F&O
- 36.Hardwood F&O
- 37.Softwood TG
- 38.Mixed Wood TG
- 39.Hardwood TG
- 40.Wasteland
- 41.Commercial
- 42.2nd Site
- 43.Post Rd
- 44.Lot Improvemen
- 45.Subdivision Lo
- 46.Golf Course

Bowdoin

Map Lot 05-38-0

Account 514

Location 65 LITCHFIELD RD

Card 1 Of 1 7/19/2022

Building Style 2 Ranch	SF Bsmt Living 0	Layout 1 Typical
0.Not Code 4.Cape 8.Log	Fin Bsmt Grade 0 0	1.Typical 4. 7.
1.Conv. 5.Garrison 9.Other	OCCUPANCY 0	2.Inadeq 5. 8.
2.Ranch 6.Split 10.DW	Heat Type 100% 1 Hot Water BB	3.Poor 6. 9.
3.R Ranch 7.Contemp 11.Church	0.Not Code 4.Steam 8.FI/Wall	Attic 9 None
Dwelling Units 1	1.HWBB 5.FWA 9.No Heat	1.1/4 Fin 4.Full Fin 7.
Other Units 0	2.HWCI 6.GravWA 11.	2.1/2 Fin 5.FI/Stair 8.
Stories 1 One Story	3.H Pump 7.Electric 12.	3.3/4 Fin 6. 9.None
1.1 4.1.5 7.4	Cool Type 0% 9 None	Insulation 1 Full
2.2 5.1.75 8.20	1.Refrig 4.W&C Air 7.	1.Full 4.Minimal 7.
3.3 6.2.5 9.Yurt	2.Evapor 5. 8.	2.Heavy 5. 8.
Exterior Walls 2 Vinyl/Aluminum	3.H Pump 6. 9.None	3.Capped 6. 9.None
0.Not Code 4.Asbestos 8.Concrete	Kitchen Style 2 Typical	Unfinished % 0%
1.Wood 5.Stucco 9.Other	1.Modern 4.Obsolete 7.	Grade & Factor 3 Average 100%
2.Vin/Al 6.Brick 10.Board B	2.Typical 5. 8.	1.E Grade 4.B Grade 7.
3.Compos. 7.Stone 12.	3.Old Type 6. 9.None	2.D Grade 5.A Grade 8.
Roof Surface 3 Sheet Metal	Bath(s) Style 2 Typical Bath(s)	3.C Grade 6.AA Grade 9.Same
1.Asphalt 4.Composit 7.	1.Modern 4.Obsolete 7.	SQFT (Footprint) 864
2.Slate 5.Wood 8.	2.Typical 5. 8.	Condition 3 Below Average
3.Metal 6.Other 9.	3.Old Type 6. 9.None	1.Poor 4.Avg 7.V G
SF Masonry Trim 0	# Rooms 6	2.Fair 5.Avg+ 8.Exc
SEPTIC DESIGN 0	# Bedrooms 3	3.Avg- 6.Good 9.Same
BLDG PERMIT 0	# Full Baths 1	Phys. % Good 90%
Year Built 1973	# Half Baths 1	Funct. % Good 100%
Year Remodeled 0	# Addn Fixtures 0	Functional Code 9 None
Foundation 5 Concrete Slab	# Fireplaces 0	1.Incomp 4.Delap 7.No Power
1.Concrete 4.Wood 7.	 <p>TRIO Software A Division of Harris Computer Systems</p>	2.O-Built 5.Bsmt 8.LongTerm
2.C Block 5.Slab 8.		3.Damage 6.Dbwld 9.None
3.Br/Stone 6.Piers 9.		Econ. % Good 100%
Basement 9 No Basement		Economic Code None
1.1/4 Bmt 4.Full Bmt 7.		0.None 3.No Power 7.
2.1/2 Bmt 5.None 8.		1.Location 4.Generate 8.
3.3/4 Bmt 6. 9.None		2.Encroach 9.None 9.
Bsmt Gar # Cars 0		Entrance Code 5 Estimated
Wet Basement 0		1.Interior 4.Vacant 7.Entered
1.Dry 4. 7.		2.Refusal 5.Estimate 8.No
2.Damp 5. 8.	3.Informed 6.Reviewed 9.Land	
3.Wet 6. 9.	Information Code 5 Estimate	
	1.Owner 4.Agent 7.	
	2.Relative 5.Estimate 8.	
	3.Tenant 6.Other 9.	

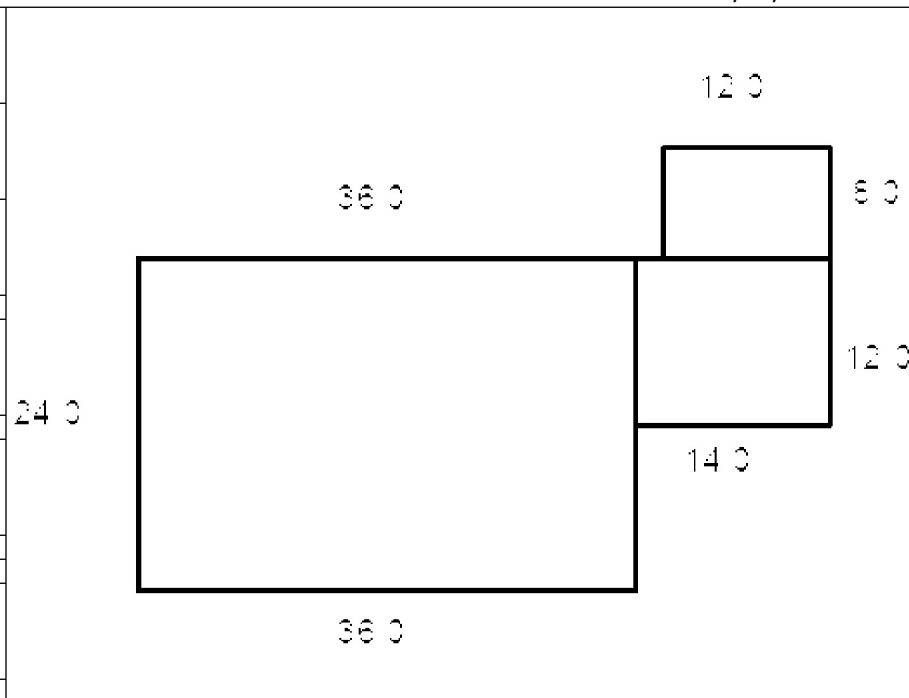

Date Inspected

Additions, Outbuildings & Improvements

Type	Year	Units	Grade	Cond	Phys.	Funct.	Sound Value
22 Encl Frame Porch	0	168	0 0	0	0 %	0 %	
68 Wood Deck	0	96	0 0	0	0 %	0 %	
24 Frame Shed	0	80	2 100	3	0 %	100 %	
30 Detached Garage	0	576	2 100	3	0 %	100 %	
67 Stable	1985	440	2 100	2	0 %	100 %	
49 Storage space	0	288	2 100	3	0 %	100 %	
					%	%	
					%	%	
					%	%	
					%	%	
					%	%	



THIBEAULT, ETHAN E
338 LEWIS HILL RD
BOWDOIN ME 04287

B2373P293 B2021RP3435

Previous Owner
THIBEAULT, CATHLEEN E
1174 AUGUSTA RD

BOWDOIN ME 04287
Sale Date: 4/20/2021

Previous Owner
COUTURE, GEORGE M.
186 LITCHFIELD RD

BOWDOIN ME 04287
Sale Date: 3/16/2004

Inspection Witnessed By:

X	Date	Date Insp.
No./Date	Description	Date Insp.

Notes:

Bowdoin

Property Data			Assessment Record						
Neighborhood 5 Map 5			Year	Land	Buildings	Exempt	Total		
Tree Growth Year 0			2009	55,940	21,090	0	77,030		
Farmland Yr 0			2010	55,940	21,410	0	77,350		
Open Space Yr 0			2011	55,940	21,410	0	77,350		
Zone/Land Use 11 Residential 1			2012	90,540	21,410	0	111,950		
Secondary Zone			2013	90,540	19,920	0	110,460		
Topography			2014	90,540	19,920	0	110,460		
1.Level 4.Below St 7.LevelBog			2015	90,540	18,420	0	108,960		
2.Rolling 5.Low 8.Conform			2016	90,540	18,420	0	108,960		
3.Above St 6.FZone 9.Non-Confor			2017	90,540	18,420	0	108,960		
Utilities			2018	90,540	18,420	0	108,960		
1.Public 4.Dr Well 7.Cesspool			2019	90,540	18,420	0	108,960		
2.Water 5.Dug Well 8.			2020	90,540	18,420	0	108,960		
3.Sewer 6.Septic 9.None			2021	90,540	18,420	0	108,960		
Street 1 Paved			2022	90,540	17,560	0	108,100		
1.Paved 4.Proposed 7.MHG			Land Data						
2.Semi Imp 5.R/O/W 8.DIS									
3.Gravel 6.MHP 9.None			Front Foot	Type	Effective		Influence		Influence Codes
TG PLAN YEAR 0			11.Road Frontage		Frontage	Depth	Factor	Code	
Tif District # 0			12.Delta Triangle						1.Unimproved
Sale Data			13.Nabla Triangle						2.Excess Frtg
Sale Date 4/20/2021			14.Rear Land						3.Topography
Price			15.Miscellaneous						4.Size/Shape
Sale Type 1 Land Only									5.Access
1.Land 4.Mobile 7.C/I L&B									6.Restriction
2.L & B 5.Other 8.			Square Foot	Square Feet					7.Open Space
3.Building 6.C/I Land 9.			16.Regular Lot						8.View/Environ
Financing 9 Unknown			17.Secondary Lot						9.Fract Share
1.Convent 4.Seller 7.			18.Hydro Facility						Acres
2.FHA/VA 5.Private 8.			19.Improvements						30.Rear Land 3
3.Assumed 6.Cash 9.Unknown			20.Base 3 (Fract)						31.Tillable
Validity 2 Related Parties									32.Pasture
1.Valid 4.Split 7.Renovate			Fract. Acre	Acres/Sites					33.Orchard
2.Related 5.Partial 8.Other			21.Base 1 (Fract)	24	1.00	100	%	0	34.Softwood F&O
3.Distress 6.Exempt 9.Short			22.Base 2 (Fract)	28	1.10	100	%	0	35.Mixed Wood F&O
Verified 5 Public Record			23.Base 3	51	1.00	100	%	0	36.Hardwood F&O
1.Buyer 4.Agent 7.Family			Acres	44	2.00	100	%	0	37.Softwood TG
2.Seller 5.Pub Rec 8.Other			24.Base 1						38.Mixed Wood TG
3.Lender 6.MLS 9.			25.Base 2						39.Hardwood TG
			26.Frontage 1						40.Wasteland
			27.Rear Land 4						41.Commercial
			28.Rear Land 1						42.2nd Site
			29.Rear Land 2						43.Post Rd
			Total Acreage		3.10				44.Lot Improvemen
									45.Subdivision Lo
									46.Golf Course

Bowdoin

Map Lot 05-39-0

Account 515

Location 84 LITCHFIELD RD

Card 1 Of 1 7/19/2022

Building Style 0 Not Coded	SF Bsmt Living 0	Layout 0
0.Not Code 4.Cape 8.Log	Fin Bsmt Grade 0 0	1.Typical 4. 7.
1.Conv. 5.Garrison 9.Other	OCCUPANCY 0	2.Inadeq 5. 8.
2.Ranch 6.Split 10.DW	Heat Type 100% 0 Not Coded	3.Poor 6. 9.
3.R Ranch 7.Contemp 11.Church	0.Not Code 4.Steam 8.FI/Wall	Attic 0
Dwelling Units 0	1.HWBB 5.FWA 9.No Heat	1.1/4 Fin 4.Full Fin 7.
Other Units 0	2.HWCI 6.GravWA 11.	2.1/2 Fin 5.FI/Stair 8.
Stories 0	3.H Pump 7.Electric 12.	3.3/4 Fin 6. 9.None
1.1 4.1.5 7.4	Cool Type 0% 9 None	Insulation 0
2.2 5.1.75 8.20	1.Refrig 4.W&C Air 7.	1.Full 4.Minimal 7.
3.3 6.2.5 9.Yurt	2.Evapor 5. 8.	2.Heavy 5. 8.
Exterior Walls 0 Not Coded	3.H Pump 6. 9.None	3.Capped 6. 9.None
0.Not Code 4.Asbestos 8.Concrete	Kitchen Style 0	Unfinished % 0%
1.Wood 5.Stucco 9.Other	1.Modern 4.Obsolete 7.	Grade & Factor 0 0%
2.Vin/Al 6.Brick 10.Board B	2.Typical 5. 8.	1.E Grade 4.B Grade 7.
3.Compos. 7.Stone 12.	3.Old Type 6. 9.None	2.D Grade 5.A Grade 8.
Roof Surface 0	Bath(s) Style 0	3.C Grade 6.AA Grade 9.Same
1.Asphalt 4.Composit 7.	1.Modern 4.Obsolete 7.	SQFT (Footprint) 0
2.Slate 5.Wood 8.	2.Typical 5. 8.	Condition 0
3.Metal 6.Other 9.	3.Old Type 6. 9.None	1.Poor 4.Avg 7.V G
SF Masonry Trim 0	# Rooms 0	2.Fair 5.Avg+ 8.Exc
SEPTIC DESIGN 0	# Bedrooms 0	3.Avg- 6.Good 9.Same
BLDG PERMIT 0	# Full Baths 0	Phys. % Good 0%
Year Built 0	# Half Baths 0	Funct. % Good 100%
Year Remodeled 0	# Addn Fixtures 0	Functional Code 9 None
Foundation 0	# Fireplaces 0	1.Incomp 4.Delap 7.No Power
1.Concrete 4.Wood 7.		2.O-Built 5.Bsmt 8.LongTerm
2.C Block 5.Slab 8.		3.Damage 6.Dbwd 9.None
3.Br/Stone 6.Piers 9.		Econ. % Good 100%
Basement 0		Economic Code None
1.1/4 Bmt 4.Full Bmt 7.		0.None 3.No Power 7.
2.1/2 Bmt 5.None 8.		1.Location 4.Generate 8.
3.3/4 Bmt 6. 9.None		2.Encroach 9.None 9.
Bsmt Gar # Cars 0		Entrance Code 3 Information Only
Wet Basement 0		1.Interior 4.Vacant 7.Entered
1.Dry 4. 7.		2.Refusal 5.Estimate 8.No
2.Damp 5. 8.	3.Informed 6.Reviewed 9.Land	
3.Wet 6. 9.	Information Code 6 Other	
	1.Owner 4.Agent 7.	
	2.Relative 5.Estimate 8.	
	3.Tenant 6.Other 9.	

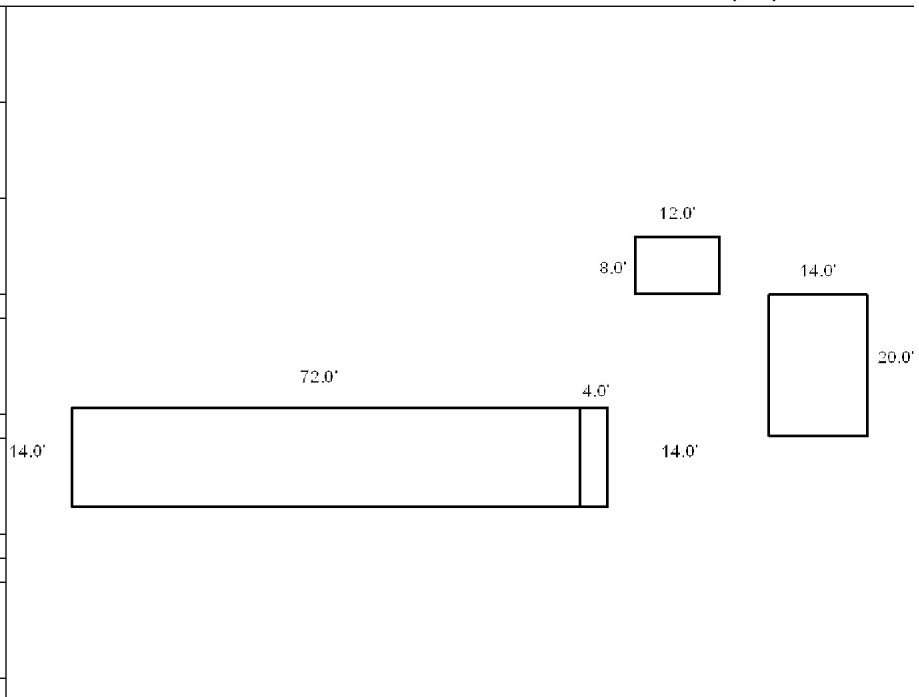

Date Inspected 3/23/2012

Additions, Outbuildings & Improvements

Type	Year	Units	Grade	Cond	Phys.	Funct.	Sound Value
998 14Mobile Home	1985	14x72	3 90	3	0 %	100 %	
21 Open Frame	1985	56	3 100	3	0 %	100 %	
30 Detached Garage	1985	280	2 90	2	0 %	80 %	
82 Gazabeo	2008	96	3 100	3	0 %	100 %	
73 M/H Skirting	1985	172	2 100	2	0 %	100 %	
					%	%	
					%	%	
					%	%	
					%	%	
					%	%	
					%	%	
					%	%	
					%	%	
					%	%	
					%	%	
					%	%	
					%	%	



ALEXANDER, JASON K
ALEXANDER, KATHLEEN L
68 LITCHFIELD RD
BOWDOIN ME 04287

B2294P118

Inspection Witnessed By:

X	Date	Date Insp.
No./Date	Description	Date Insp.

Notes:

Bowdoin

Property Data			Assessment Record						
Neighborhood 5 Map 5			Year	Land	Buildings	Exempt	Total		
Tree Growth Year 0			2009	49,340	130,270	0	179,610		
Farmland Yr 0			2010	49,340	130,270	0	179,610		
Open Space Yr 0			2011	49,340	130,270	0	179,610		
Zone/Land Use 11 Residential 1			2012	56,340	130,270	0	186,610		
Secondary Zone			2013	56,340	130,270	0	186,610		
Topography			2014	56,340	130,270	0	186,610		
1.Level 4.Below St 7.LevelBog			2015	56,340	130,270	0	186,610		
2.Rolling 5.Low 8.Conform			2016	56,340	130,270	0	186,610		
3.Above St 6.FZone 9.Non-Confor			2017	56,340	130,270	0	186,610		
Utilities			2018	56,340	130,270	0	186,610		
1.Public 4.Dr Well 7.Cesspool			2019	56,340	130,270	0	186,610		
2.Water 5.Dug Well 8.			2020	56,340	130,270	0	186,610		
3.Sewer 6.Septic 9.None			2021	56,340	130,270	0	186,610		
Street 5 Right-Of-Way			2022	56,340	124,380	0	180,720		
1.Paved 4.Proposed 7.MHG			Land Data						
2.Semi Imp 5.R/O/W 8.DIS									
3.Gravel 6.MHP 9.None			Front Foot	Type	Effective		Influence		Influence Codes 1.Unimproved 2.Excess Frtg 3.Topography 4.Size/Shape 5.Access 6.Restriction 7.Open Space 8.View/Environ 9.Fract Share Acres 30.Rear Land 3 31.Tillable 32.Pasture 33.Orchard 34.Softwood F&O 35.Mixed Wood F&O 36.Hardwood F&O 37.Softwood TG 38.Mixed Wood TG 39.Hardwood TG 40.Wasteland 41.Commercial 42.2nd Site 43.Post Rd 44.Lot Improvemen 45.Subdivision Lo 46.Golf Course
TG PLAN YEAR 0			11.Road Frontage		Frontage	Depth	Factor	Code	
Tif District # 0			12.Delta Triangle				%		
Sale Data			13.Nabla Triangle				%		
Sale Date 10/10/2003			14.Rear Land				%		
Price			15.Miscellaneous				%		
Sale Type							%		
1.Land 4.Mobile 7.C/I L&B			Square Foot	Square Feet					
2.L & B 5.Other 8.			16.Regular Lot				%		
3.Building 6.C/I Land 9.			17.Secondary Lot				%		
Financing			18.Hydro Facility				%		
1.Convent 4.Seller 7.			19.Improvements				%		
2.FHA/VA 5.Private 8.			20.Base 3 (Fract)				%		
3.Assumed 6.Cash 9.Unknown							%		
Validity 3 Distressed Sale			Fract. Acre	Acres/Sites					
1.Valid 4.Split 7.Renovate			21.Base 1 (Fract)	51	1.00	100	%	0	
2.Related 5.Partial 8.Other			22.Base 2 (Fract)	28	10.60	100	%	0	
3.Distress 6.Exempt 9.Short			23.Base 3	44	1.00	100	%	0	
Verified			Acres				%		
1.Buyer 4.Agent 7.Family			24.Base 1				%		
2.Seller 5.Pub Rec 8.Other			25.Base 2				%		
3.Lender 6.MLS 9.			26.Frontage 1				%		
			27.Rear Land 4				%		
			28.Rear Land 1				%		
			29.Rear Land 2				%		
			Total Acreage 11.60						

Bowdoin

Map Lot 05-39-01

Account 516

Location 68 LITCHFIELD RD

Card 1

Of 1

7/19/2022

Building Style 7 Contemporary	SF Bsmt Living 0	Layout 1 Typical	
0.Not Code 4.Cape 8.Log	Fin Bsmt Grade 0 0	1.Typical 4. 7.	<div style="border: 2px solid black; width: 100%; height: 100%; display: flex; align-items: center; justify-content: center;"> <div style="text-align: center;"> <p style="font-size: 2em; margin: 0;">28 0</p> <p style="font-size: 2em; margin: 0;">32 0</p> <p style="font-size: 2em; margin: 0;">28 0</p> </div> </div>
1.Conv. 5.Garrison 9.Other	OCCUPANCY 0	2.Inadeq 5. 8.	
2.Ranch 6.Split 10.DW	Heat Type 100% 1 Hot Water BB	3.Poor 6. 9.	
3.R Ranch 7.Contemp 11.Church	0.Not Code 4.Steam 8.F/Wall	Attic 9 None	
Dwelling Units 1	1.HWBB 5.FWA 9.No Heat	1.1/4 Fin 4.Full Fin 7.	
Other Units 0	2.HWCI 6.GravWA 11.	2.1/2 Fin 5.F/Stair 8.	
Stories 2 Two Story	3.H Pump 7.Electric 12.	3.3/4 Fin 6. 9.None	
1.1 4.1.5 7.4	Cool Type 0% 9 None	Insulation 1 Full	
2.2 5.1.75 8.20	1.Refrig 4.W&C Air 7.	1.Full 4.Minimal 7.	
3.3 6.2.5 9.Yurt	2.Evapor 5. 8.	2.Heavy 5. 8.	
Exterior Walls 2 Vinyl/Aluminum	3.H Pump 6. 9.None	3.Capped 6. 9.None	
0.Not Code 4.Asbestos 8.Concrete	Kitchen Style 2 Typical	Unfinished % 0%	
1.Wood 5.Stucco 9.Other	1.Modern 4.Obsolete 7.	Grade & Factor 3 Average 100%	
2.Vin/Al 6.Brick 10.Board B	2.Typical 5. 8.	1.E Grade 4.B Grade 7.	
3.Compos. 7.Stone 12.	3.Old Type 6. 9.None	2.D Grade 5.A Grade 8.	
Roof Surface 1 Asphalt Shingles	Bath(s) Style 2 Typical Bath(s)	3.C Grade 6.AA Grade 9.Same	
1.Asphalt 4.Composit 7.	1.Modern 4.Obsolete 7.	SQFT (Footprint) 896	
2.Slate 5.Wood 8.	2.Typical 5. 8.	Condition 4 Average	
3.Metal 6.Other 9.	3.Old Type 6. 9.None	1.Poor 4.Avg 7.V G	
SF Masonry Trim 0	# Rooms 6	2.Fair 5.Avg+ 8.Exc	
SEPTIC DESIGN 0	# Bedrooms 2	3.Avg- 6.Good 9.Same	
BLDG PERMIT 0	# Full Baths 1	Phys. % Good 0%	
Year Built 1995	# Half Baths 0	Funct. % Good 100%	
Year Remodeled 0	# Addn Fixtures 0	Functional Code 9 None	
Foundation 5 Concrete Slab	# Fireplaces 0	1.Incomp 4.Delap 7.No Power	
1.Concrete 4.Wood 7.		2.O-Built 5.Bsmt 8.LongTerm	
2.C Block 5.Slab 8.		3.Damage 6.Dbwd 9.None	
3.Br/Stone 6.Piers 9.		Econ. % Good 100%	
Basement 9 No Basement		Economic Code None	
1.1/4 Bmt 4.Full Bmt 7.		0.None 3.No Power 7.	
2.1/2 Bmt 5.None 8.		1.Location 4.Generate 8.	
3.3/4 Bmt 6. 9.None		2.Encroach 9.None 9.	
Bsmt Gar # Cars 0		Entrance Code 3 Information Only	
Wet Basement 0		1.Interior 4.Vacant 7.Entered	
1.Dry 4. 7.		2.Refusal 5.Estimate 8.No	
2.Damp 5. 8.	3.Informed 6.Reviewed 9.Land		
3.Wet 6. 9.	Information Code 1 Owner		
	1.Owner 4.Agent 7.		
	2.Relative 5.Estimate 8.		
	3.Tenant 6.Other 9.		

Date Inspected

Additions, Outbuildings & Improvements

Type	Year	Units	Grade	Cond	Phys.	Funct.	Sound Value
24 Frame Shed	1991	400	3 100	4	0 %	100 %	
					%	%	
					%	%	
					%	%	
					%	%	
					%	%	
					%	%	
					%	%	
					%	%	
					%	%	
					%	%	
					%	%	
					%	%	
					%	%	
					%	%	
					%	%	
					%	%	
					%	%	
					%	%	
					%	%	
					%	%	
					%	%	



THIBEAULT, ETHAN E
338 LEWIS HILL RD
BOWDOIN ME 04287

B2373P293 B2021RP3435

Previous Owner
THIBEAULT, CATHLEEN E
1174 AUGUSTA RD

BOWDOIN ME 04287
Sale Date: 4/20/2021

Inspection Witnessed By:

X	Date	
No./Date	Description	Date Insp.

Notes:

Bowdoin

Property Data			Assessment Record						
Neighborhood 5 Map 5			Year	Land	Buildings	Exempt	Total		
Tree Growth Year 0			2009	0	14,280	0	14,280		
Farmland Yr 0			2010	0	14,280	0	14,280		
Open Space Yr 0			2011	0	14,280	0	14,280		
Zone/Land Use 11 Residential 1			2012	0	14,280	0	14,280		
Secondary Zone			2013	0	14,280	0	14,280		
Topography			2014	0	14,280	0	14,280		
1.Level 4.Below St 7.LevelBog			2015	0	14,280	0	14,280		
2.Rolling 5.Low 8.Conform			2016	0	14,280	0	14,280		
3.Above St 6.FZone 9.Non-Confor			2017	0	14,280	0	14,280		
Utilities			2018	0	14,280	0	14,280		
1.Public 4.Dr Well 7.Cesspool			2019	0	14,280	0	14,280		
2.Water 5.Dug Well 8.			2020	0	14,280	0	14,280		
3.Sewer 6.Septic 9.None			2021	0	14,280	0	14,280		
Street 1 Paved			2022	0	14,230	0	14,230		
1.Paved 4.Proposed 7.MHG			Land Data						
2.Semi Imp 5.R/O/W 8.DIS			Front Foot	Type	Effective		Influence		Influence Codes
3.Gravel 6.MHP 9.None					Frontage	Depth	Factor	Code	
TG PLAN YEAR 0			11.Road Frontage					1.Unimproved	
Tif District # 0			12.Delta Triangle					2.Excess Frtg	
Sale Data			13.Nabla Triangle					3.Topography	
Sale Date 4/20/2021			14.Rear Land					4.Size/Shape	
Price			15.Miscellaneous					5.Access	
Sale Type 4 Mobile Home			Square Foot		Square Feet				6.Restriction
1.Land 4.Mobile 7.C/I L&B			16.Regular Lot					7.Open Space	
2.L & B 5.Other 8.			17.Secondary Lot					8.View/Environ	
3.Building 6.C/I Land 9.			18.Hydro Facility					9.Fract Share	
Financing 9 Unknown			19.Improvements					Acres	
1.Convent 4.Seller 7.			20.Base 3 (Fract)					30.Rear Land 3	
2.FHA/VA 5.Private 8.			Fract. Acre		Acreege/Sites				31.Tillable
3.Assumed 6.Cash 9.Unknown			21.Base 1 (Fract)					32.Pasture	
Validity 2 Related Parties			22.Base 2 (Fract)					33.Orchard	
1.Valid 4.Split 7.Renovate			23.Base 3					34.Softwood F&O	
2.Related 5.Partial 8.Other			Acres						35.Mixed Wood F&O
3.Distress 6.Exempt 9.Short			24.Base 1					36.Hardwood F&O	
Verified 5 Public Record			25.Base 2					37.Softwood TG	
1.Buyer 4.Agent 7.Family			26.Frontage 1					38.Mixed Wood TG	
2.Seller 5.Pub Rec 8.Other			27.Rear Land 4					39.Hardwood TG	
3.Lender 6.MLS 9.			28.Rear Land 1					40.Wasteland	
			29.Rear Land 2					41.Commercial	
			Total Acreage		0.00				42.2nd Site
									43.Post Rd
									44.Lot Improvemen
									45.Subdivision Lo
									46.Golf Course

Bowdoin

Map Lot 05-39-A

Account 517

Location 82 LITCHFIELD RD

Card 1 Of 1 7/19/2022

Building Style 0 Not Coded	SF Bsmt Living 0	Layout 0
0.Not Code 4.Cape 8.Log	Fin Bsmt Grade 0 0	1.Typical 4. 7.
1.Conv. 5.Garrison 9.Other	OCCUPANCY 0	2.Inadeq 5. 8.
2.Ranch 6.Split 10.DW	Heat Type 100% 0 Not Coded	3.Poor 6. 9.
3.R Ranch 7.Contemp 11.Church	0.Not Code 4.Steam 8.FI/Wall	Attic 0
Dwelling Units 0	1.HWBB 5.FWA 9.No Heat	1.1/4 Fin 4.Full Fin 7.
Other Units 0	2.HWCI 6.GravWA 11.	2.1/2 Fin 5.FI/Stair 8.
Stories 0	3.H Pump 7.Electric 12.	3.3/4 Fin 6. 9.None
1.1 4.1.5 7.4	Cool Type 0% 9 None	Insulation 0
2.2 5.1.75 8.20	1.Refrig 4.W&C Air 7.	1.Full 4.Minimal 7.
3.3 6.2.5 9.Yurt	2.Evapor 5. 8.	2.Heavy 5. 8.
Exterior Walls 0 Not Coded	3.H Pump 6. 9.None	3.Capped 6. 9.None
0.Not Code 4.Asbestos 8.Concrete	Kitchen Style 0	Unfinished % 0%
1.Wood 5.Stucco 9.Other	1.Modern 4.Obsolete 7.	Grade & Factor 0 0%
2.Vin/Al 6.Brick 10.Board B	2.Typical 5. 8.	1.E Grade 4.B Grade 7.
3.Compos. 7.Stone 12.	3.Old Type 6. 9.None	2.D Grade 5.A Grade 8.
Roof Surface 0	Bath(s) Style 0	3.C Grade 6.AA Grade 9.Same
1.Asphalt 4.Composit 7.	1.Modern 4.Obsolete 7.	SQFT (Footprint) 0
2.Slate 5.Wood 8.	2.Typical 5. 8.	Condition 0
3.Metal 6.Other 9.	3.Old Type 6. 9.None	1.Poor 4.Avg 7.V G
SF Masonry Trim 0	# Rooms 0	2.Fair 5.Avg+ 8.Exc
SEPTIC DESIGN 0	# Bedrooms 0	3.Avg- 6.Good 9.Same
BLDG PERMIT 0	# Full Baths 0	Phys. % Good 0%
Year Built 0	# Half Baths 0	Funct. % Good 100%
Year Remodeled 0	# Addn Fixtures 0	Functional Code 9 None
Foundation 0	# Fireplaces 0	1.Incomp 4.Delap 7.No Power
1.Concrete 4.Wood 7.		2.O-Built 5.Bsmt 8.LongTerm
2.C Block 5.Slab 8.		3.Damage 6.Dbwd 9.None
3.Br/Stone 6.Piers 9.		Econ. % Good 100%
Basement 0		Economic Code None
1.1/4 Bmt 4.Full Bmt 7.		0.None 3.No Power 7.
2.1/2 Bmt 5.None 8.		1.Location 4.Generate 8.
3.3/4 Bmt 6. 9.None		2.Encroach 9.None 9.
Bsmt Gar # Cars 0		Entrance Code 5 Estimated
Wet Basement 0		1.Interior 4.Vacant 7.Entered
1.Dry 4. 7.		2.Refusal 5.Estimate 8.No
2.Damp 5. 8.		3.Informed 6.Reviewed 9.Land
3.Wet 6. 9.		Information Code 5 Estimate
		1.Owner 4.Agent 7.
		2.Relative 5.Estimate 8.
		3.Tenant 6.Other 9.



Date Inspected 4/27/2009

Additions, Outbuildings & Improvements

Type	Year	Units	Grade	Cond	Phys.	Funct.	Sound Value	
998 14Mobile Home	1984	14x67	3 100	3	0 %	100 %		1.One Story Fram
73 M/H Skirting	1984	162	2 100	2	0 %	100 %		2.Two Story Fram
					%	%		3.Three Story Fr
					%	%		4.1 & 1/2 Story
					%	%		5.1 & 3/4 Story
					%	%		6.2 & 1/2 Story
					%	%		21.Open Frame Por
					%	%		22.Encl Frame Por
					%	%		23.Attached Garag
					%	%		24.Frame Shed
					%	%		25.Frame Bay Wind
					%	%		26.1SFr Overhang
					%	%		27.Unfin Basement
					%	%		28.Unfinished Att
					%	%		29.Finished Attic

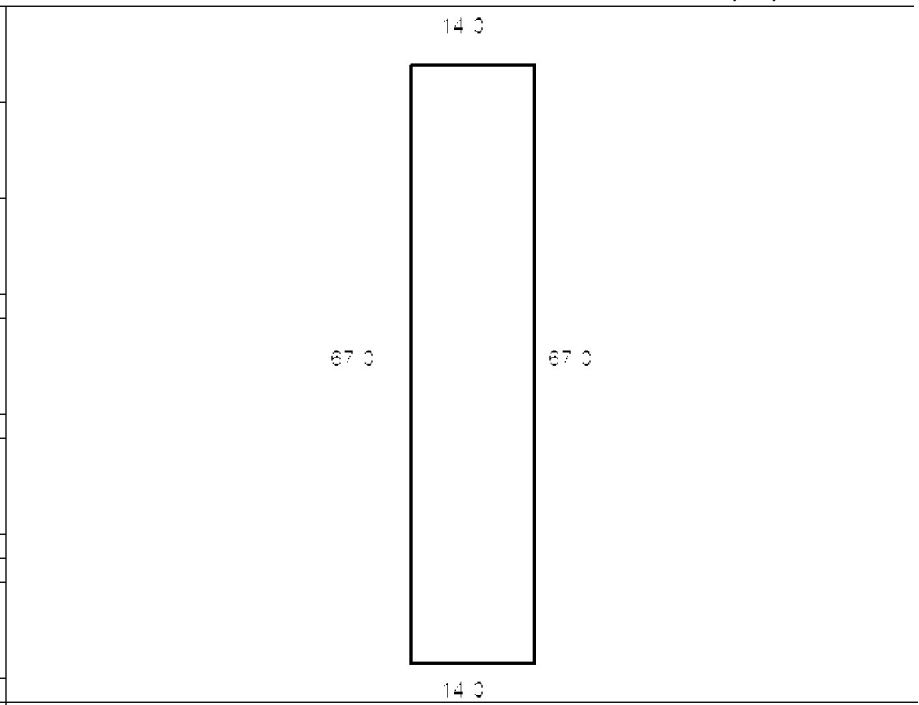

MOCKLER, JULIE E
79 LITCHFIELD RD
BOWDOIN ME 04287

B911P188 B3424P349 B3548P345 B3598P133

Previous Owner
COUTURE, GEORGE M
186 LITCHFIELD RD

BOWDOIN ME 04287
Sale Date: 6/03/2014

Previous Owner
LaSALLE BANK NATIONAL ASSOCIATION
c/o EMC MacARTHUR RIDGE II
909 HODDEN RIDGE DR, SUITE 200
IRVING TX 75038
Sale Date: 9/30/2013

Previous Owner
CHAVIS, WILLIE
CHAVIS, TSIANINA
79 LITCHFIELD RD
BOWDOIN ME 04287
Sale Date: 9/04/2012

Inspection Witnessed By:

X	Date
No./Date	Description
	Date Insp.

Notes:

Bowdoin

Property Data			Assessment Record						
Neighborhood 5 Map 5			Year	Land	Buildings	Exempt	Total		
Tree Growth Year 0			2009	49,740	47,140	13,000	83,880		
Farmland Yr 0			2010	49,740	47,140	10,000	86,880		
Open Space Yr 0			2011	49,740	47,140	10,000	86,880		
Zone/Land Use 11 Residential 1			2012	49,740	47,140	10,000	86,880		
Secondary Zone			2013	49,740	39,760	0	89,500		
Topography			2014	49,740	41,010	0	90,750		
1.Level 4.Below St 7.LevelBog			2015	49,740	41,010	0	90,750		
2.Rolling 5.Low 8.Conform			2016	49,740	41,010	0	90,750		
3.Above St 6.FZone 9.Non-Confor			2017	49,740	41,010	0	90,750		
Utilities			2018	49,740	41,010	0	90,750		
1.Public 4.Dr Well 7.Cesspool			2019	49,740	43,440	0	93,180		
2.Water 5.Dug Well 8.			2020	49,740	43,440	25,000	68,180		
3.Sewer 6.Septic 9.None			2021	49,740	43,440	25,000	68,180		
Street 1 Paved			2022	49,740	31,080	21,500	59,320		
1.Paved 4.Proposed 7.MHG			Land Data						
2.Semi Imp 5.R/O/W 8.DIS									
3.Gravel 6.MHP 9.None			Front Foot	Type	Effective		Influence		Influence Codes
TG PLAN YEAR 0			11.Road Frontage		Frontage	Depth	Factor	Code	
Tif District # 0			12.Delta Triangle				%		1.Unimproved
Sale Data			13.Nabla Triangle				%		2.Excess Frtg
Sale Date 5/30/2014			14.Rear Land				%		3.Topography
Price 105,000			15.Miscellaneous				%		4.Size/Shape
Sale Type 2 Land & Buildings							%		5.Access
1.Land 4.Mobile 7.C/I L&B							%		6.Restriction
2.L & B 5.Other 8.			Square Foot	Square Feet					7.Open Space
3.Building 6.C/I Land 9.			16.Regular Lot				%		8.View/Environ
Financing 9 Unknown			17.Secondary Lot				%		9.Fract Share
1.Convent 4.Seller 7.			18.Hydro Facility				%		Acres
2.FHA/VA 5.Private 8.			19.Improvements				%		30.Rear Land 3
3.Assumed 6.Cash 9.Unknown			20.Base 3 (Fract)				%		31.Tillable
Validity 7 Renovations							%		32.Pasture
1.Valid 4.Split 7.Renovate			Fract. Acre	Acres/Sites					33.Orchard
2.Related 5.Partial 8.Other			21.Base 1 (Fract)	24	1.00	100	%	0	34.Softwood F&O
3.Distress 6.Exempt 9.Short			22.Base 2 (Fract)	28	1.60	100	%	0	35.Mixed Wood F&O
Verified 5 Public Record			23.Base 3	44	1.00	100	%	0	36.Hardwood F&O
1.Buyer 4.Agent 7.Family			Acres				%		37.Softwood TG
2.Seller 5.Pub Rec 8.Other			24.Base 1				%		38.Mixed Wood TG
3.Lender 6.MLS 9.			25.Base 2				%		39.Hardwood TG
			26.Frontage 1				%		40.Wasteland
			27.Rear Land 4				%		41.Commercial
			28.Rear Land 1				%		42.2nd Site
			29.Rear Land 2				%		43.Post Rd
			Total Acreage		2.60				44.Lot Improvemen
									45.Subdivision Lo
									46.Golf Course

Bowdoin

Map Lot 05-40-0

Account 518

Location 79 LITCHFIELD RD

Card 1

Of 1

7/19/2022

Building Style	SF Bsmt Living	Layout
0.Not Code 4.Cape 8.Log	Fin Bsmt Grade	1.Typical 4. 7.
1.Conv. 5.Garrison 9.Other	OCCUPANCY	2.Inadeq 5. 8.
2.Ranch 6.Split 10.DW	Heat Type 100%	3.Poor 6. 9.
3.R Ranch 7.Contemp 11.Church	0.Not Code 4.Steam 8.FI/Wall	Attic
Dwelling Units	1.HWBB 5.FWA 9.No Heat	1.1/4 Fin 4.Full Fin 7.
Other Units	2.HWCI 6.GravWA 11.	2.1/2 Fin 5.FI/Stair 8.
Stories	3.H Pump 7.Electric 12.	3.3/4 Fin 6. 9.None
1.1 4.1.5 7.4	Cool Type 0%	Insulation
2.2 5.1.75 8.20	1.Refrig 4.W&C Air 7.	1.Full 4.Minimal 7.
3.3 6.2.5 9.Yurt	2.Evapor 5. 8.	2.Heavy 5. 8.
Exterior Walls	3.H Pump 6. 9.None	3.Capped 6. 9.None
0.Not Code 4.Asbestos 8.Concrete	Kitchen Style	Unfinished %
1.Wood 5.Stucco 9.Other	1.Modern 4.Obsolete 7.	Grade & Factor
2.Vin/Al 6.Brick 10.Board B	2.Typical 5. 8.	1.E Grade 4.B Grade 7.
3.Compos. 7.Stone 12.	3.Old Type 6. 9.None	2.D Grade 5.A Grade 8.
Roof Surface	Bath(s) Style	3.C Grade 6.AA Grade 9.Same
1.Asphalt 4.Composit 7.	1.Modern 4.Obsolete 7.	SQFT (Footprint)
2.Slate 5.Wood 8.	2.Typical 5. 8.	Condition
3.Metal 6.Other 9.	3.Old Type 6. 9.None	1.Poor 4.Avg 7.V G
SF Masonry Trim	# Rooms	2.Fair 5.Avg+ 8.Exc
SEPTIC DESIGN	# Bedrooms	3.Avg- 6.Good 9.Same
BLDG PERMIT	# Full Baths	Phys. % Good
Year Built	# Half Baths	Funct. % Good
Year Remodeled	# Addn Fixtures	Functional Code
Foundation	# Fireplaces	1.Incomp 4.Delap 7.No Power
1.Concrete 4.Wood 7.		2.O-Built 5.Bsmt 8.LongTerm
2.C Block 5.Slab 8.		3.Damage 6.Dbwd 9.None
3.Br/Stone 6.Piers 9.		Econ. % Good
Basement		Economic Code
1.1/4 Bmt 4.Full Bmt 7.		0.None 3.No Power 7.
2.1/2 Bmt 5.None 8.		1.Location 4.Generate 8.
3.3/4 Bmt 6. 9.None		2.Encroach 9.None 9.
Bsmt Gar # Cars		Entrance Code 3 Information Only
Wet Basement		1.Interior 4.Vacant 7.Entered
1.Dry 4. 7.		2.Refusal 5.Estimate 8.No
2.Damp 5. 8.	3.Informed 6.Reviewed 9.Land	
3.Wet 6. 9.	Information Code 1 Owner	
		1.Owner 4.Agent 7.
		2.Relative 5.Estimate 8.
		3.Tenant 6.Other 9.

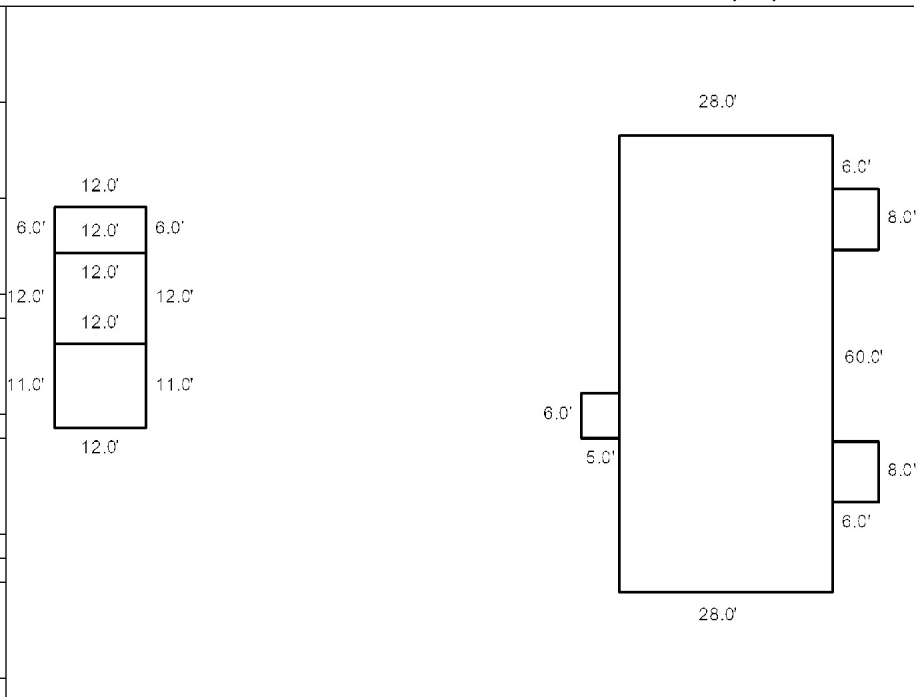

Date Inspected 3/27/2019

Additions, Outbuildings & Improvements

Type	Year	Units	Grade	Cond	Phys.	Funct.	Sound Value
68 Wood Deck	2013	30	3 100	3	0 %	100 %	
68 Wood Deck	2013	48	3 100	3	0 %	100 %	
992 Doublewide	1995	26x60	2 100	3	0 %	100 %	
97 Slab for MoHo	1995	1680	3 100	3	0 %	100 %	
73 M/H Skirting	1995	172	2 100	2	0 %	100 %	
68 Wood Deck	2013	48	3 100	3	0 %	100 %	
24 Frame Shed	2018	144	3 100	3	0 %	100 %	
115 3 Sided Shed	2018	132	3 100	3	0 %	100 %	
70 Shed Roof	2018	72	3 100	3	0 %	100 %	
					%	%	

